

Instructions for use



made for me[®]

wearable breast pump



0423642
Model: 1203
Version No:C-1

Hands down, hands-free is best

With all the performance you'd expect from a regular electric breast pump, our wearable design fits comfortably in your bra so you can go about your day with total freedom.

Questions?

Contact our customer care team on 08085 979 899

For tips, tricks and troubleshooting,
please visit tommeetippee.com



Please download the Tommee Tippee app
which is available on Android and iOS app store.

Contents

1.	Quick connection guide	2
2.	Comfort and performance guide	4
3.	Parts	6
a.	Product description	6
b.	Parts	7
4.	Getting started	8
a.	Assembly	8
b.	Cleaning and sterilising	10
c.	Charging	11
d.	Horn sizing	11
5.	Using your pump	12
a.	On-pump controls	12
b.	Turning it on	13
c.	Aligning your nipple	13
d.	Starting your session	14
e.	Choosing your intensity and mode	14
f.	Automatic functions	15
g.	Ending your session	15
h.	Direct-to-feed and storage	15
6.	Troubleshooting	16
7.	Safety information	18

1. Quick connection guide

If you can't wait to get started with your new pump, here's a handy guide to help you get the most out of it.



Please download the Tommee Tippee app which is available on android and iOS app store.



iOS

Use QR code to download app for iOS device



Android

Use QR code to download app for Android device



For more information, tips and tricks on using the app, visit tommeetippee.com and search 'in-bra wearable'.

Your pump can also be used offline. Simply press the power button and use the left and right buttons  to adjust intensity. In offline mode, the power button shows solid white.

Pairing

Once you've downloaded the Tommee Tippee app and registered your account, pairing is really simple.

You will need to pair each pump independently.

Follow the below instructions to pair the device.

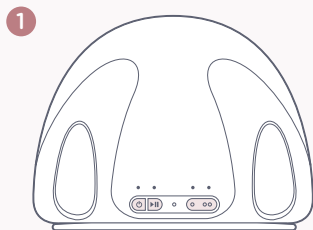

Press the power button  on the top of the pump



The pump should appear as a pop up on your app home screen, allowing you to pair with the tap of a button.

If no pop up appears, you just need to press the  in the top right corner and select the pump. Your phone will search for the pump and pair it. Once paired, the pump is ready to use.

2. Comfort and performance guide

Getting the most out of your pump

We know that in order to get the most from your pump, comfort and fit are really important. Your Tommee Tippee In-Bra Wearable pump comes with unique features designed to help.

Nipple alignment guide

The nipple alignment guide is a red light that projects out of the horn and onto your breast when you first turn on the pump. This light helps you guide your nipple into the centre of the horn which we know is important for both comfort and output.

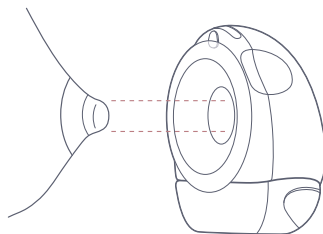

Horn sizes

Did you know that the fit of your nipple in your horn can influence comfort and milk flow? We've included a 24mm and 28mm horn as standard so recommend you trying both to find which works for you.

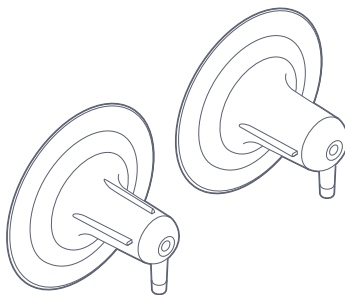

24mm

28mm



Bra adjusters

Another important consideration is the fit of your pump in your bra. Too much compression can feel uncomfortable, too little can feel insecure. We've included bra adjusters in your pack just in case you need them. Hook them on to your nursing bra to extend the cup.

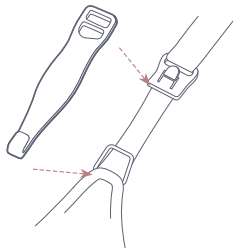

Intensity and mode

Once your pump is aligned, fits well and is comfortable to wear, the only thing left is to choose your preferred settings.

We offer two modes, massage and expression.

Massage mode (also called Stimulation) encourages the initial let down of milk. A lower pressure is applied at a higher frequency, similar to how babies initially suck when they first latch on.

Expression mode effectively and efficiently draws milk out after let down at a lower frequency in the same way that babies do when drinking milk. Choose between 8 pressure levels to find the most comfortable, most effective setting for you.



In the app, you can switch between massage and expression mode whenever you like because every person and every session is different.

3. Parts

a. Product description

Your Tommee Tippee wearable breast pump comes with everything you need to prepare, pump, feed and store milk.

Part	Single	Double
A	1 x 24mm horn / flange	2 x 24mm horns / flanges
B	1 x 28mm horn / flange	2 x 28mm horns / flanges
C	2 x bra adjusters	2 x bra adjusters
D	1 x nipple / teat	2 x nipples / teats
E	1 x screw ring	2 x screw rings
F	1 x pump	2 x pumps
G	2 x upper lids	4 x upper lids
H	2 x diaphragm assemblies	4 x diaphragm assemblies
I	2 x lower lids	4 x lower lids
J	2 x duck valves	4 x duck valves
K	2 x collector bottles	4 x collector bottles
L	1 x USB charging cable and multi-region plug	1 x USB charging cable with 2 heads (shown opposite) and multi-region plug
M	1 x carry bag	1 x carry bag

Tip: Before using your pump for the first time, we recommend a full charge using the cable and plug provided.

b. Parts

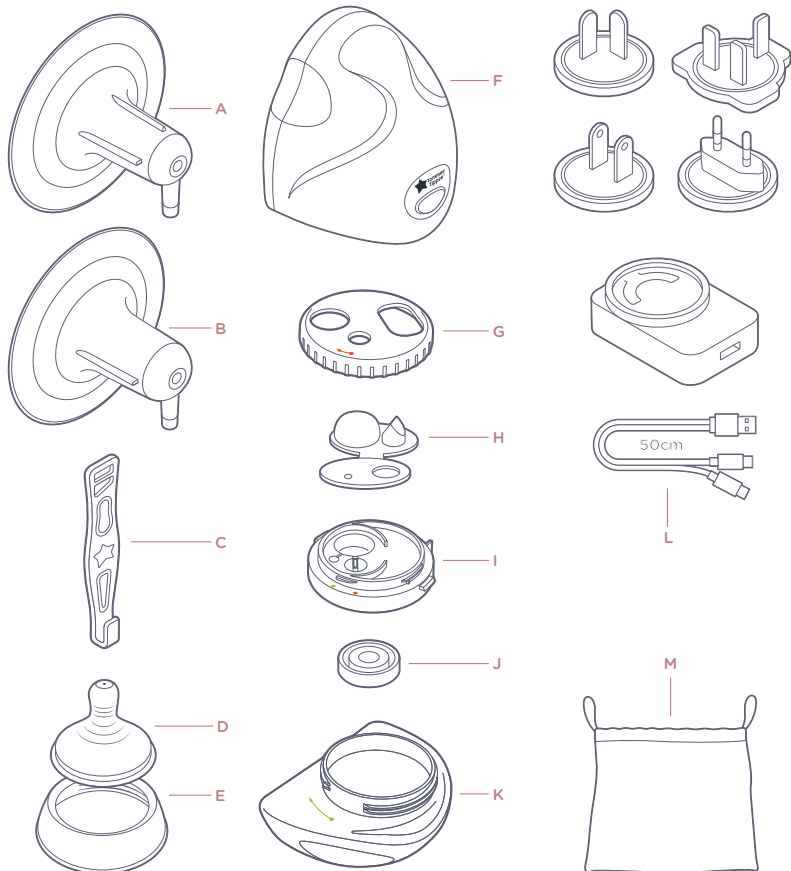

4. Getting started

a. Assembly

Your pump arrives assembled. Please disassemble, clean and sterilise before first use. See next section for cleaning and sterilising instructions.

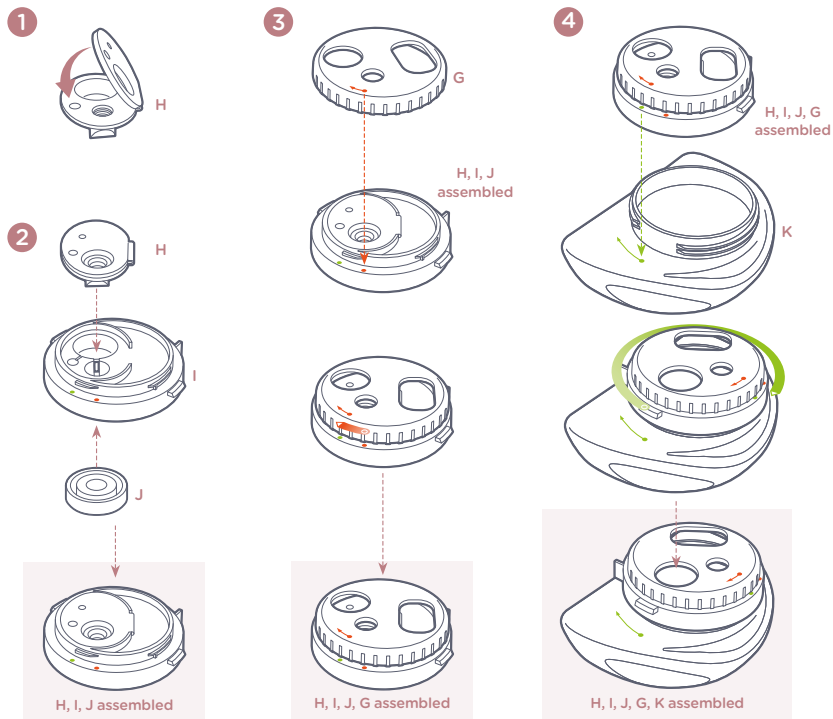

To assemble, choose your preferred horn / flange (24mm or 28mm nipple / teat diameter) and insert into the pump body (1).

With the collector bottle components assembled, clip in to the bottom of the pump body (2).

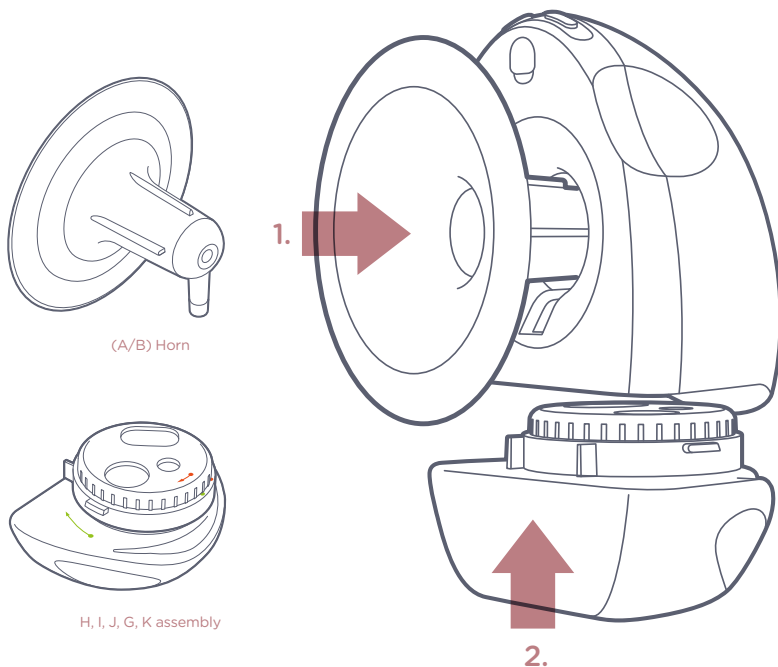

b. Cleaning and sterilising

Your wearable breast pump must be cleaned and sterilised before first use. Always disassemble components before cleaning or sterilising.

All of the parts intended for washing can go in the dishwasher and can be sterilised, including with UV. The pump body (F) should not be washed or sterilised. It contains electronics that must be kept dry. You can use a clean, damp cloth to wipe it as required.



Components that can be washed and sterilised:

Part	Single	Double
A	1 x 24mm horn / flange	2 x 24mm horns / flanges
B	1 x 28mm horn / flange	2 x 28mm horns / flanges
C	2 x bra adjusters	2 x bra adjusters
D	1 x nipple / teat	2 x nipples / teats
E	1 x screw ring	2 x screw rings
G	2 x upper lids	4 x upper lids
H	2 x diaphragm assemblies	4 x diaphragm assemblies
I	2 x lower lids	4 x lower lids
J	2 x duck valves	4 x duck valves
K	2 x collector bottles	4 x collector bottles

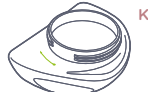

c. Charging

When the battery is low, the battery light will pulse red until charge reaches 80%, at which point it will turn solid green. When charging, the battery light will pulse red until it reaches 50%, at which point it will pulse green. The pump cannot be used whilst charging.

You should use the cable and plug provided. A full charge offers up to 4 hours of use per pump.

Please make sure the device is turned off before plugging in the USB cable to charge. The device turns off automatically after 10 minutes of idle time.

d. Horn / flange sizing

We include 24mm and 28mm horns / flanges as standard so you can choose the one that is most comfortable for you. With the horn / flange disassembled from the pump body, place it over your breast to assess fit.

We recommend measuring the diameter of your nipple so you're familiar with your size.

Alternatively, use the outlines here to measure your nipple.

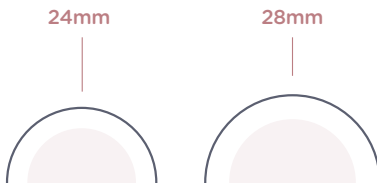

5. Using your pump

b. On-pump controls

1. Turn on

light showing white (offline) or blue (paired)



2. Choose breast

light showing on L or R side to denote breast



3. Press start/stop

light showing white



4. Battery

each state (solid green, red, pulsing red)



5. Battery (charging)

(solid green or red pulsing)



6. Intensity

left or right toggle - no change to illumination

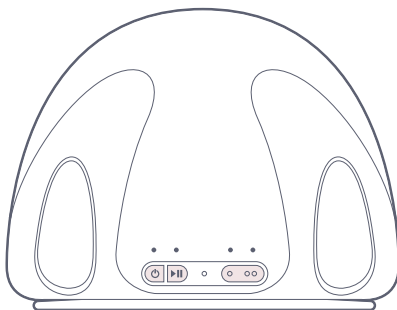

b. Turning it on

Once fully assembled, press the power button  to turn the pump on.

c. Aligning your nipple

Correct nipple alignment is a really key factor in milk production, much like a deep latch in breast feeding. Your new pump includes a unique nipple alignment guiding light that makes it easy to align your nipple, even in low-light. Turn your pump on and direct the red spotlight towards your nipple. Hold your breast with your other hand and move the pump closer to your nipple, ensuring the centre of the spotlight stays in the centre of your nipple until the pump is in place.

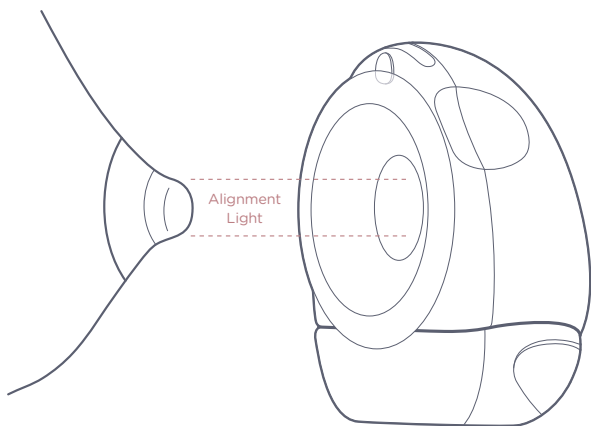

d. Starting your session

Once the pump is turned on and in position, press play/pause to start pumping. If you need to pause pumping at any point, press play/pause. For a more discreet and convenient user experience, use your Tommee Tippee app to play/pause.

e. Choosing your intensity and mode

Your wearable breast pump offers two modes – massage and expression. We know every mum and every day is different so, in the app, you can move between modes with the tap of a button at any point during your session.

Massage mode (also known as stimulation mode) uses a higher frequency, lower intensity suction which mimics how your baby first stimulates the breast to encourage milk flow. Expression mode uses slower sucks to draw your milk out and into the collector bottles effectively. Some prefer to alternate, others find one setting and stick with it.

In expression mode, there are 8 intensity settings. Choose a level that is comfortable for you. Remember this may well change per session and even per breast. Remember a higher intensity setting does not always mean a higher volume of milk. Your comfort is more important.

f. Automatic functions

Your wearable breast pump will automatically pause when the bottle is full. If you want to continue to pump, you will need to submit the session so it is registered in the analysis page in your app before you empty the collector and start a new session.

As a safety feature, we've also limited session duration to 30 minutes, at the end of which the pump will pause and you will be unable to restart. If you do want to continue, you will need to start a new session.

The pump will also pause if you lean too far over in order to reduce the risk of leaking. This is unlikely to occur in general use but if it does, simply sit/stand back up straight and resume pumping.

The lights on the pump (nipple alignment spotlight and button lights) will automatically turn off after 1 minute during use for discretion. Press any button to re-illuminate the lights.

g. Ending your session

Once you have finished your session, pause and finish the cycle and follow instructions in the app to collect every last drop, leaning forward for a moment before using your finger to break the seal between pump and breast.

At this stage you can also manually alter the volume if you find the amount shown in the app doesn't quite match up to what's in the collector bottle. Foremilk has a lighter consistency than hindmilk which can impact the accuracy of the reading.

Once the session has been added to the analysis page, you can simply turn the pump off, wash and sterilise the parts that require it and charge the pump body as required.

When you're ready to remove the collector bottle, simply press the large button at the front of the pump to release the latch that holds the bottle in place.

h. Direct-to-feed and storage

To make it even easier to feed breast milk once you've expressed, the milk collector is compatible with our nipples / teats so you can use like a bottle.

Simply assemble the teat to the screw ring, attach to the milk collector and you're ready to feed.

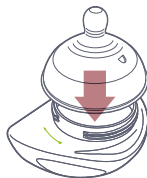

To store, simply remove the collector bottle sub-assembly from the pump and put in the fridge or freezer as preferred

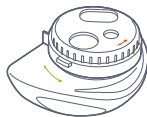

Alternatively, store your breastmilk in line with healthcare guidelines.

6. Troubleshooting

Why is the amount the app tells me I've pumped different from how much is in the collector bottle?

The pump uses a sensor to estimate the amount of milk in the collector bottle. This can be affected by a number of things like milk consistency (foremilk vs. hindmilk), movement, angle of use and sensor interference. Ensure the small black sensor is free of debris and sit/stand upright and stationary at the end of your session for best results.

How do I convert the collector bottle into a feeding bottle?

Simply remove the diaphragm and lid assembly from the top of the collector bottle, assemble the nipple / teat and screw ring and screw in place.

How do I store milk in the collector bottle?

Your pack comes with spare parts so the entire collector bottle assembly can be stored in the fridge or freezer until you are ready to feed with it.

Why won't my pump pair to the app?

The pump uses Bluetooth to pair to your phone. Download the Tommee Tippee app, register an account and login in. Turn on the pump and then press and hold the power button until the LED light flashes blue. You will see a pop-up appear in the Tommee Tippee app and can then add the pump. Please note you will need to do this for each pump if you have bought a pair.

What if I'm not getting enough milk?

There are lots of reasons why your milk production fluctuates over time but if you know you're getting less than "normal" there are a few things to try.

- Check the alignment of your nipple in the pump – it's important that the centre of your nipple is inserted at the centre of the horn / flange.
- Check the size of the horn / flange you are using – it's important that the horn / flange feels comfortable and doesn't draw in too much of your breast tissue.
- Check the seal when the pump is running – the pump should feel very secure once the program starts.
- Check the fit in your bra – if the pump feels "squashed" against your breasts, try one of the provided bra adjusters to loosen the fit slightly.
- Check the intensity settings – finding a setting that is comfortable and effective will produce the best combination of comfort and output.

How do I upgrade my firmware?

The Tommee Tippee In-Bra pump is smart which means it can evolve over time, even after you've purchased it. Where it results in a better experience for the consumer, we will update the app periodically. It's important that you keep the app up to date so you have access to the latest features.

In the app, you will receive a notification if there is an update available so we recommend keeping the app downloaded on your phone.

Why doesn't the suction feel like it did?

There are two valves in the milk collector bottle assembly. They can be a little sticky if not properly cleaned so we recommend pinching them to ensure they can open prior to assembly. The other thing to ensure is that the collector bottle is inserted firmly in the bottom of the pump.

Finally, try charging your pump fully to see if that resolves the problem.

7. Safety information

CLOSER TO NATURE® SLOW FLOW TEAT AND RING

For your child's safety and health

Please read and retain the instruction guide for future reference as it includes important information.

WARNING!

- Always use this product with adult supervision. Accidents have occurred when babies have been left alone with drinking equipment due to the baby falling or if the product has disassembled.
- Never use feeding teats as a soother.
- Continuous and prolonged sucking of fluids will cause tooth decay. Tooth decay in young children can occur even when non-sweetened fluids are used. This can occur if the baby is allowed to use the bottle for long periods through the day and particularly through the night when saliva flow is reduced or if it is used as a soother.
- Always check food temperature before feeding. Heating in a microwave oven may produce localised high temperatures. Take extra care when microwave heating. Always stir heated food to ensure even heat distribution and test the temperature before serving.
- Throw away at the first signs of damage or weakness.

- Keep components not in use out of the reach of children
- Never attach to cords, ribbons, laces or loose parts of clothing. The child can be strangled.
- The hygiene cap can pose a suffocation hazard-keep out of the reach of children.

CLEANING & STERILISATION

- Before first use place in boiling water for 5 minutes. This is to ensure hygiene.
- Clean before each use.
- Always wash the product immediately after use.
- Wash in warm soapy water and rinse in clean water or use a dishwasher (top shelf only).
- Do not clean with solvents or harsh chemicals.
- Do not allow product to come into contact with oil-based foods (e.g. oil/tomato based sauces) as staining may occur.
- Do not turn the teat inside out for cleaning. Damage could result. Use a teat brush.

STORAGE AND USE

- Inspect before each use and pull the feeding teat in all directions.
- Do not store or leave in direct sunlight or near a source of heat.
- Do not store with or allow to come into contact with solvents or harsh chemicals.
- Not suitable for use in a conventional oven or a combination microwave oven with the grill feature switched on.
- Do not leave a feeding teat in direct sunlight or heat or leave in disinfectant ("sterilising solution") for longer than recommended as this may weaken the teat.
- For safety and hygiene reasons it is recommended that the feeding teat is replaced at least every 2 months.
- Do not heat in a microwave with bottle sealed. Remove teat, locking ring and dome cap.

MADE FOR ME® WEARABLE BREAST PUMP

IMPORTANT WARNINGS!/IMPORTANT SAFEGUARDS

Please keep this instruction guide for future reference as it includes important information.

You can also find these instructions at **tommeeippee.com**.

- To protect against fire, electric shock and injury to persons, do not immerse motor unit, USB cable and adapter, or air tubes in water or other liquid.
- Do not place the power unit in a microwave oven or steam sterilizer.
- Do NOT WASH the air tubes or adapter. This will result in bacteria build up and can

lead to pump failure. Washing or sterilizing the air tubes will invalidate the warranty and will damage the power unit.

- Do not place the air tubes in a microwave or electric steam sterilizer or boiling water as they will melt.
- Misuse of the appliance may result in the risk of fire, electric shock and/or personal injury.
- Do not clean with solvents or harsh chemicals.
- This appliance should not be used or played with by children. Keep the pump, its air tubes and USB cable out of reach of children under 8 years old.
- The appliance can be used by persons with reduced physical, sensory or mental capabilities or lack of experience and knowledge if they have been given supervision or instruction concerning use of the appliance in a safe way and understand the hazards involved.
- User maintenance, other than cleaning and sterilizing is not required.
- Do not open the power unit, it contains no user serviceable parts and will invalidate the warranty.
- Do not operate any appliance with a damaged USB cable or motor casing. If the appliance malfunctions or has been damaged please contact tommeeippee.com.
- If the damage is from new the unit must be returned to manufacturer.
- Do not leave the appliance in direct sunlight.
- Do not store below freezing or above 113°F.
- If damaged within a retail warranty period, this appliance should be exchanged at place of purchase. The manufacturer will then be made aware.
- Do not use any accessories other than those supplied with this appliance.

- The appliance should not be used adjacent or stacked with other equipment as the two appliances may interfere with each other.
- Do not allow appliance to come into contact with oil-based foods (e.g. oil/ tomato based sauces) as staining will occur.
- This appliance is a personal care product and therefore cannot be returned once opened, unless faulty.
- Only use the adapter and USB cable supplied with this product.
- Do not use whilst in transit.

For domestic use only - not intended for commercial or institutional use.

SAVE THESE INSTRUCTIONS

Any questions? Visit our website **tommeetippee.com**.

- This product is only to be connected to Class II Equipment bearing the following symbol: 
- Only plugs that are approved to BS1363 should be used (UK only).
- Only use this product on a stable and level surface.
- Make sure you store your monitor in a safe place when not in use, away from heat and water.
- Do not submerge in water.
- Take care not to drop either unit as this may affect the functioning of your monitor.
- Do not attempt to remove, replace or repair the battery from this product.
- This appliance is not intended for use by persons (including children) with reduced physical, sensory or mental capabilities, or lack of experience and knowledge,

unless they have been given supervision or instruction concerning use of the appliance by a person responsible for their safety.

- Children should be supervised to ensure that they do not play with the appliance
- This appliance can be used by children aged from 8 years and above and persons with reduced physical, sensory or mental capabilities or lack of experience and knowledge if they have been given supervision or instruction concerning use of the appliance in a safe way and understand the hazards involved. Children shall not play with the appliance. Cleaning and user maintenance shall not be made by children without supervision.

Technical Information

- Model: 1203
- Input: 5V \approx 1A
- Battery Type: Built-in lithium-ion battery
- Voltage: 3.7 V \approx
- Battery Capacity: 1400 mAh
- Device Frequency Band: 2500-2600 kHz
- Adapter Information;
Input: 100-240V-50/60Hz 0.4A
Output: 5.0V \approx 1.0/ 2.0A 10.0W

Regulatory Information

Information on the Disposal of Waste Electrical and Electronic Equipment (WEEE).

This symbol means that your product shall be disposed of separately from household waste in accordance with local laws and regulations. When this product is ready for disposal, take it to a collection point designated by local authorities. Separating and recycling of your product at the time

of disposal will help conserve natural resources and ensure that the product is recycled in a manner that protects human health and the environment. Penalties may be applicable for the incorrect disposal of this product in accordance with national legislation.

This product contains a battery which is permanently built into the product for safety and performance reasons. The battery should not require replacement during the lifetime of the product. It should only be removed by skilled service personnel. Dispose of this product as electrical waste to ensure the correct waste treatment of the battery.

RED Declaration

Mayborn (UK) Limited hereby declares that this product is in compliance with the essential requirements and other relevant provisions of Directive 2014/53/EU and all other applicable EU directive requirements. The complete declaration of conformity can be found at: www.tommeetippee.com/en-gb/product-support

Made in China



Note: This equipment has been tested and found to comply with the limits for a Class B digital device, pursuant to part 15 of the FCC Rules. These limits are designed to provide reasonable protection against harmful interference in a residential installation.

This equipment generates, uses and can radiate radio frequency energy and

if not installed and used in accordance with the instructions, may cause harmful interference with radio communications in the vicinity. However, there is no guarantee that interference will not occur in a particular installation.

If this equipment does cause harmful interference to radio, television, or other devices, which can be determined by turning the requirement off and on, the user is encouraged to try to correct the interference by one or more of the following measures:

- Reorient or relocate the receiving antenna
- Increase the separation between the equipment and receiver

IP22

IP22 indicates that the unit is resistant to condensation and finger entry.



Compliance with Federal Communications Commission Requirements.



Keep the device dry.



The product contains a Lithium Ion Battery.

Voltage 5v+
Power 10W

The power and voltage consumed by the device when plugged into a USB socket.



The product is double insulated (Class II appliance).



In some countries this is a medical appliance and this indicates that this product has Applied Parts.



Warning!



Serial number

Guidance and Manufacturer's Declaration

Below cables information are provided for EMC reference.

Cable	Max. cable length, Shielded/unshielded		Number	Cable classification
DC Power Line (USB Cable)	0.5m	Unshielded	1 Set	DC Power

Important information regarding Electro Magnetic Compatibility (EMC)

This electrical medical equipment needs special precautions regarding EMC and put into service according to the EMC information provided in the user manual; The equipment conforms to this IEC 60601-1-2:2014 standard for both immunity and emissions. Nevertheless, special precautions need to be observed:

- The equipment with Following ESSENTIAL PERFORMANCE is intended used in Home healthcare environment

ESSENTIAL PERFORMANCE: the breast pump with anti backflow design, max suction pressure is not exceed -300mmHg.

- WARNING: Use of this equipment adjacent to or stacked with other equipment should be avoided because it could result in improper operation. If such use is necessary, this equipment and the other equipment should be observed to verify that they are operating normally".
- The use of accessories, transducers and cables other than those specified or provided by the manufacturer of this equipment could result in increased electromagnetic emissions or decreased electromagnetic immunity of this equipment and result in improper operation.
- WARNING: Portable RF communications equipment (including peripherals such as antenna cables and external antennas) should be used no closer than 30 cm (12 inches) to any part of this product, including cables specified by the manufacturer. Otherwise, degradation of the performance of this equipment could result."
- WARNING: If the use location is near (e.g. less than 1.5 km from) AM, FM or TV broadcast antennas, before using this equipment, it should be observed to verify that it is operating normally to assure that the equipment remains safe with regard to electromagnetic disturbances throughout the expected service life.
- STATEMENT: For the purpose of its operation, the equipment has wireless communication function, it includes RF transmitter and receiver, 2.4GHz, Pulse modulation.

EMI Compliance Table (Table 1)

Table 1 - Emission

Phenomenon	Compliance	Electromagnetic environment
RF emissions	CISPR 11 Group 1, Class B	Home healthcare environment
Harmonic distortion	IEC 61000–3–2 Class A	Home healthcare environment
Voltage fluctuations and flicker	IEC 61000–3–3 Compliance	Home healthcare environment

EMS Compliance Table (Table 2-4)

Table 2 - Enclosure Port

Phenomenon	Basic EMC standard	Immunity test levels
		Home healthcare environment
Electrostatic Discharge	IEC 61000–4–2	±8 kV contact ±2kV, ±4kV, ±8kV, ±15kV air
Radiated RF EM field	IEC 61000–4–3	10V/m 80MHz–2.7GHz 80% AM at 1kHz
Proximity fields from RF wireless communications equipment	IEC 61000–4–3	Refer to table 3
Rated power frequency magnetic fields	IEC 61000–4–8	30A/m 50Hz or 60Hz

Table 3 – Proximity fields from RF wireless communications equipment

Test frequency (MHz)	Band (MHz)	Immunity test levels
		Home healthcare environment
385	380–390	Pulse modulation 18Hz, 27V/m
450	430–470	FM, ± 5 kHz deviation, 1kHz sine, 28V/m
710	704–787	Pulse modulation 217Hz, 9V/m
745		
780		
810	800–960	Pulse modulation 18Hz, 28V/m
870		
930		
1720	1700–1990	Pulse modulation 217Hz, 28V/m
1845		
1970		
2450	2400–2570	Pulse modulation 217Hz, 28V/m
5240	5100–5800	Pulse modulation 217Hz, 9V/m
5500		
5785		

Table 4 – Input a.c. power Port

Phenomenon	Basic EMC standard	Immunity test levels
		Home healthcare environment
Electrical fast transients/burst	IEC 61000-4-4	±2 kV 100kHz repetition frequency
Surges Line-to-line	IEC 61000-4-5	±0.5 kV, ±1 kV
Conducted disturbances induced by RF fields	IEC 61000-4-6	3V, 0.15MHz–80MHz 6V in ISM bands and amateur radio bands between 0.15MHz and 80MHz 80%AM at 1kHz
Voltage dips	IEC 61000-4-11	0% UT; 0.5 cycle At 0°, 45°, 90°, 135°, 180°, 225°, 270° and 315°
		0% UT; 1 cycle and 70% UT; 25/30 cycles Single phase: at 0°
Voltage interruptions	IEC 61000-4-11	0% UT; 250/300 cycles

Please take attention that changes or modification not expressly approved by the party responsible for compliance could void the user's authority to operate the equipment.

This device complies with Part 15 of the FCC Rules. Operation is subject to the following two conditions:

- (1) This device may not cause harmful interference, and
- (2) This device must accept any interference received, including interference that may cause undesired operation.

Working Condition

Rated temperature range: 5°C to 40°C

Rated relative humidity: 20%-80%

Rated atmospheric Pressure: 850Hpa - 1060Hpa

Long-term storage should be kept in a dry and cool place

Transport & Storage condition

Temperature: -20°C to 55°C

Humidity: 20% - 80%

Atmospheric pressure: 850Hpa - 1060Hpa

Mayborn (UK) Ltd
Mayborn House, Balliol Business Park, Newcastle Upon Tyne NE12 8EW
UNITED KINGDOM

Mayborn USA Inc.
1010 Washington Boulevard, 11th Floor, Stamford, CT 06901
UNITED STATES OF AMERICA

EU Representative
Mayborn France Sarl, 56 Rue de paris, Boulogne Billancourt, 92100
FRANCE

Mayborn ANZ Pty Ltd.
(ABN 66 154 703 134) PO Box 475, Mt Waverley VIC 3149
AUSTRALIA

Newborn Brands (NZ) Ltd.
PO Box 47-677, Ponsonby, Auckland 1144
NEW ZEALAND

Let us know
what you think

We'd love to hear what you think of our
wearable breast pump. Share your photos,
reviews and tell us about your
experiences on our social channels.



Any questions?
Visit our website: tommeetippee.com