

# PROFESSIONAL WATER JET FLOSSER & ORAL IRRIGATOR



User Guide

## WARNINGS

- **Please read all instructions thoroughly and retain for future reference.**
- This appliance can be used by children aged 8 years and above and persons with reduced physical, sensory or mental capabilities or lack of experience and knowledge if they have been given supervision or instruction concerning the use of the appliance in a safe way and understand the hazards involved. Children shall not play with the appliance. Cleaning and maintenance shall not be made by children without supervision.
- This appliance must only be supplied at safety extra low voltage corresponding to the marking on the appliance. If any part of the mains adapter or cord are damaged, discontinue use. Contact Customer Care to arrange a replacement.
- Do not immerse product in water. Do NOT use solvents or abrasive cleaners.
- Do NOT use this product if it is not working properly, or if it has been dropped or damaged.
- Ensure the unit is off and disconnected from the power source when filling with water and cleaning the water reservoir.
- Keep out of reach from children and pets.
- Do not store the product where it can fall or be pulled into the bath or sink.

- There are no user serviceable parts inside the unit.
- Keep away from any appliances which are sensitive to water to avoid accidents.
- To prevent bacteria from propagating, ensure the unit and nozzle(s) are thoroughly washed with soapy water and leave to dry before storing.
- Do not fill the reservoir with water warmer than 40°C.
- Fill the water reservoir with water and/or mouthwash only. Some antibacterial solutions (i.e. prescribed solutions) can shorten the life of the product.
- Do not use for any other purpose than oral cleaning.
- If you have had oral or dental surgery in the past 2 months, consult your dentist before using this product.
- Do not press the nozzle too firmly against your teeth or gums. Doing so may cause injury.
- We recommend replacing your nozzle every 6 months.
- Do not use if you have an open wound on your tongue or in your mouth.
- Do not use while wearing any oral jewelery. Remove prior to use.

## KNOW YOUR UNIT

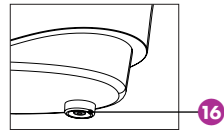
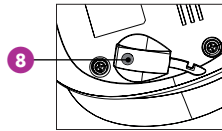
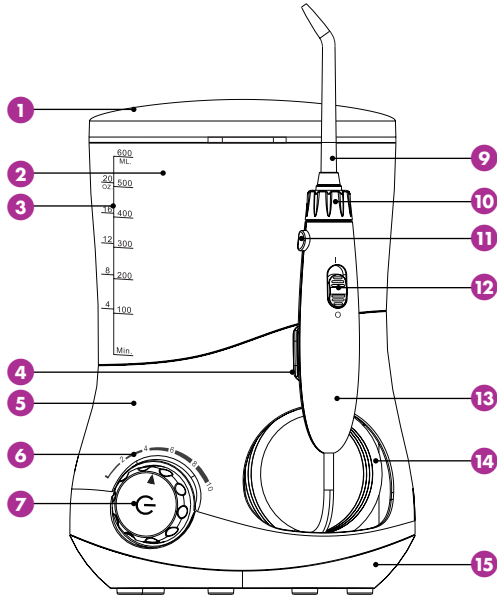

- |   |  |    |                  |
|---|--|----|------------------|
| 1 | Nozzle case  | 8  | DC jack plug     |
| 2 | Water tank   | 9  | Nozzle           |
| 3 | Volume mark  | 10 | Nozzle connector |
| 4 | Handle holder  | 11 | Release button   |
| 5 | Unit base  | 12 | Pause switch     |
| 6 | Pressure/<br>Pulse rate  | 13 | Handle           |
| 7 | Main button:<br>• Press - On/Off control<br>• Rotate - Pressure/<br>Pulse rate | 14 | Pipe             |
|   |  | 15 | Unit bottom      |
|   |  | 16 | Tank valve       |



Standard  
Nozzle x1



Tongue  
Cleanser x1



Orthodontic  
Tip x1



Pocket  
Tip x1

## GETTING STARTED

Place the device on a flat surface away from sharp objects and make sure the cord is dry and not damaged. The device is powered by a special adaptor with a DC jack connector.

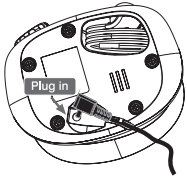

### STEP 1

Insert the plug into the DC jack on the bottom of base and plug the adaptor cord into an electrical outlet.

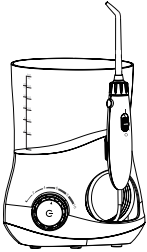

### STEP 2

Remove the Nozzle Case.



### STEP 3

Fill tank with water no warmer than 40°C and replace Nozzle Case.

## INSERTING & REMOVING NOZZLES

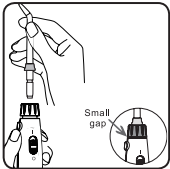

### Inserting the nozzle

Insert the tip into the centre of the Nozzle Connector until you feel it click in to place. Gently try to pull the tip out to ensure it is firmly locked in place.

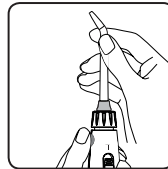

### Removing the nozzle

Press the Release Button on the handle and pull the nozzle out.

## HOW TO USE

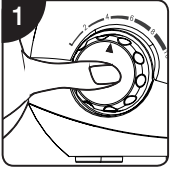

### STEP 1

When using for the first time, simply point the nozzle in to the sink, then press the Main Button to switch on the device.



### STEP 2

Rotate the Main Button on the unit to adjust water pressure/pulse rate. Slide the Pause Switch on the handle to the 'O' position to pause the water flow.



### STEP 3

Now stand over the sink and place the tip in your mouth, and then slide the Pause Switch to the 'I' position. Keep your mouth slightly open to avoid the water splashing.

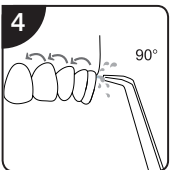

### STEP 4

Position the water jet flow at a 90° angle to the teeth and gums.

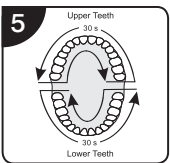

### STEP 5

Move the water jet slowly along the teeth. The water flow will briefly pause at 30 second intervals to remind you to move to the next gum line, i.e. outside, inside, top & bottom. The unit will continue to operate until the two-minute cycle is complete.

### TO SWITCH OFF

Slide the Pause Switch on the handle to the 'O' position to pause the water flow and then press the ON/OFF button.

## AFTER USE

### STEP 1

Take off the water tank and dispose of any unused water.

### STEP 2

Slide the Pause Switch to the 'I' position, point the nozzle in to the sink and power on to drain the water inside the unit, then slide the Pause Switch to the 'O' position again. Turn off the unit and unplug the adapter.

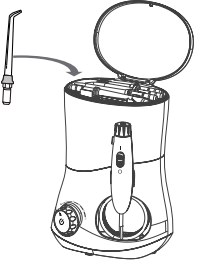

### STEP 3

Press down the Release Button, and remove the nozzle, then place it into the nozzle case.

- To clean the nozzle, remove from the handle head by pushing the nozzle release button. Rinse under a tap and dry thoroughly.
- Make sure the nozzle case and nozzle are firmly installed before switching the unit back on.

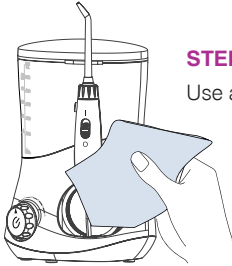

### STEP 4

Use a damp clean cloth to clean the unit.

## TIP FUNCTIONS

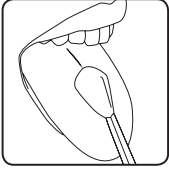

### Tongue Cleanser

To clean your tongue, gently place the tongue cleanser onto the centre midline of your tongue about halfway back. Use the light water pressure/pulse rate setting first, and gradually increase as required.

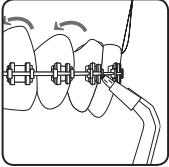

### Orthodontic Tip

The orthodontic tip is specially designed for people who wear braces. It is ideal for cleaning the hard-to-reach areas around the braces.

Slowly slide the tip along the gum-line, pausing briefly to use the brush bristles to clean the area between teeth and around the orthodontic braces.

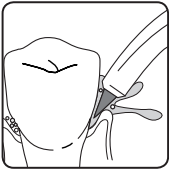

### Pocket tip

The pocket tip is specially-designed to clean periodontal pockets. Only use on the lowest pressure/pulse rate setting.

Place the soft tip against a tooth at a 45° angle and gently push the tip under the gum-line, to reach the pocket.

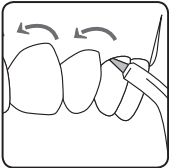



## MAINTENANCE

- Use only water or a neutral cleaning agent to clean.
- Never use caustic or abrasive agents (i.e. vinegar or limescale removers), as they may damage the appliance.
- Do not use water over 40°C in temperature.
- Keep the device away from high temperatures and avoid direct sunlight.

### Main unit

1. Remove the water tank and drain the remaining water inside the device.
2. Clean by using a damp cloth with liquid soap and dry with a soft dry cloth.
3. Do not submerge the main unit in water to clean.

### Handle

1. Wash with water and dry with a soft cloth.
2. Do not bend, pull or twist the water hose.

### Water tank

1. Wash with water and wipe with a soft, dry cloth.
2. Make sure the water tank is firmly fixed in position before storing.

### Nozzle

1. Wash with water and wipe with a soft dry cloth.
2. Place the nozzle in the storage compartment.
3. Replace the standard nozzle and tongue cleanser once every six months, and the other tips once every three months.

### Charging adaptor

Wipe the metal part of the power plug with a dry cloth once every six months.

## TROUBLESHOOTING

Problem	Possible Cause	Solution
Unit does not work	Motor not running	Make sure the adapter is firmly connected to the outlet and plugged in
		Make sure the outlet and unit power is on
Water pressure is very low	Dirt stuck in the nozzle	Clean or replace with a new nozzle
	The nozzle is deformed	Replace with a new nozzle
	Dirt stuck in the tank valve	Clean the valve and fill the tank with pure water
Water does not come out	The tank is empty	Fill the tank up
	Pause switch on	Ensure Pause switch is fully in the 'I' position
	Tank valve is not open	Press down on the tank and ensure it is correctly fitted
Tank leaks	The valve is missing	Replace with a new tank valve
	The valve isn't installed correctly	Take off the valve and reinstall again
Tear in pocket tip head	Tip head is worn	Replace with a new nozzle

## DISPOSAL



The Waste of Electrical and Electronic Equipment (WEEE) Directive (2012/19/EU) has been put in place to recycle products using best available recovery and recycling techniques to minimise the impact on the environment, treat any hazardous substances and avoid the increasing landfill. This product is classed as Electrical or Electronic equipment so please ensure that at the end of the life of this product it is disposed of in the correct manner in accordance with local authority requirements. It must NOT be disposed of with household waste.

## SPECIFICATION

**Unit Input:** DC 12V  $\approx$  1.5A, 18W

**Water Pressure:** 30-110psi



Read these instructions carefully before use and then retain for future use.



This product is for indoor use only.



This product complies with current EU product legislation.



Socket Input centre pin positive.

## CUSTOMER CARE

If you have any questions, please contact us at: [online@riobeauty.com](mailto:online@riobeauty.com)

To reorder additional accessories, please visit  
[www.riobeauty.com](http://www.riobeauty.com) or contact your local distributor.

## GUARANTEE

To register your two year guarantee online, visit: [www.riobeauty.com/warranty\\_online.htm](http://www.riobeauty.com/warranty_online.htm)



UK



[www.riobeauty.com](http://www.riobeauty.com)

© The Dezac Group Ltd 2019 Manufactured by The Dezac Group Ltd PO Box 17, Cheltenham, England GL53 7ET

1-IN-DCIC-UK/1.1