

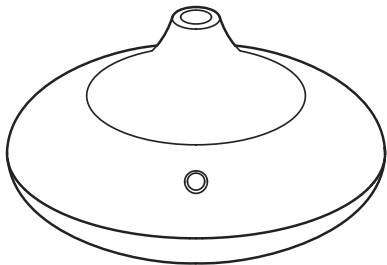

MADE BY ZEN[®]



SOTO

Aroma Diffuser with a colour changing mood light

TABLE OF CONTENTS:

A. ABOUT THE SOTO

B. TECHNICAL SPECIFICATION

C. OPERATING INSTRUCTIONS

D. FEATURES

E. MAINTENANCE

F. TROUBLESHOOTING

G. WARRANTY

Congratulations on purchasing the MADE BY ZEN® Soto Aroma Diffuser. Please keep this manual for further reference and maintenance.



ABOUT THE SOTO

Uniquely shaped, the Soto Aroma Diffuser cycles through the colour spectrum with a soothing mood light. Pause on your favourite shade to create your colourful home haven.

Relax, unwind and restore with the super fine aromatherapy mist which fills your home with scent at the touch of a button. The perfect addition to your home or office, the Soto acts a mini humidifier delivering cool mist alongside uplifting fragrance, which can aid concentration and can help de-stress and relieve tension.



LED Bulbs

The Soto has colour changing mood lighting, which easily moves through a rainbow of colours or can be set on one single colour of choice. It also has a no light option to continue soothing whilst you sleep.



Aromatherapy

Suitable for use with any essential or fragrance oils (MADE BY ZEN® oils recommended).



TECHNICAL SPECIFICATION

Model Name: SOTO Aroma Diffuser

Model No: EW010

Product Size: $\Phi 180 \times 107\text{mm}$

Voltage: DC 24V

Power: 12W

Water Capacity: 80ml

Run Time: approx. 4 hours

01. Vent hole

02. Ceramic disc

03. Water tank

04. Diffusion cone

05. Max. water level line

06. Water discharge indicator

07. Mist outlet

08. Button

09. DC Jack

10. Switching adaptor

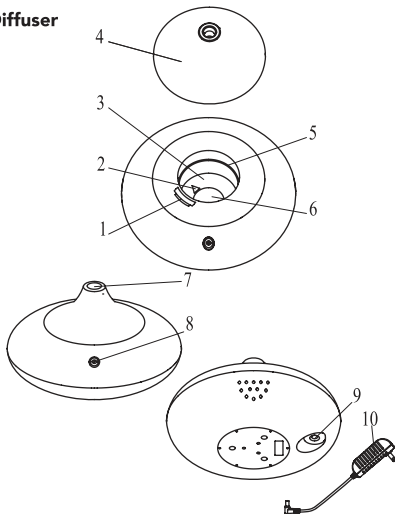

IMPORTANT NOTES BEFORE USE:

1. Place the aroma diffuser on a flat surface, at least 60cm away from the floor and at least 10cm away from the wall. **DO NOT** place the aroma diffuser on wooden or polished furniture that may be damaged by water moisture.
2. Always unplug the aroma diffuser from the mains electrical supply when cleaning or filling with water. Always use the power adaptor supplied. Ensure the cable is secure to avoid tripping or knocking over the aroma diffuser. If the power adaptor is damaged, it must be replaced with a suitable adaptor provided by the manufacturer or its agent. Alternatively, a new adaptor can be purchased from your retailer.
3. Use a suitable measuring cup to fill the water into the water tank. Never attempt to fill water under a running tap or whilst plugged in. Do not fill the water beyond the max water level line. Carefully remove the excess water from the tank, if overfilled from the water tank from the water discharge arrow – away from the vent hole.
4. The aroma diffuser must be kept out of reach from children and pets to avoid risk of injury. Children should be supervised at all times to ensure they do not play with the appliance.
5. The aroma diffuser is not intended for use by persons (including children) with reduced physical, sensory or mental capabilities or lack of experience and knowledge, unless they have been given supervision or instruction concerning use of the appliance by a person responsible for their safety.
6. Keep the aroma diffuser in a clear space to allow the mist to freely spread and away from appliances especially those sensitive to water to avoid unnecessary accidents.
7. The aroma diffuser must be cleaned after each use and should always be kept clean and dry when not in use. Never leave stagnant oil and water in the water tank for prolonged periods.
8. Never attempt to disassemble your aroma diffuser or repair the product, as this will void your warranty and create a shock hazard. Contact your retailer if an internal inspection is required.

9. In case of abnormal observations such as smoke, peculiar smells or noise, stop using the aroma diffuser immediately and contact the retailer from where you purchased it. Never wrap the adaptor with cloth or paper as blocking ventilation could increase the risk of fire.

10. Always handle the aroma diffuser with care – accidental damage is not covered under the warranty.

11. Always use water at room temperature and use only fresh, clean water from a reliable source. Do not fill the water tank with other chemicals or liquids other than water and a few drops of fragrance or essential oils.

12. Never touch the water within the water tank when the aroma diffuser is in operation as the water may become warm. It is perfectly normal for the water temperature to increase over time. Especially if it has been running for a few hours. This is caused by the energy created from the vibrating disc. The water should not exceed 40°C but for some models it can increase to 50°C (+/- 5°C). However, as the mist dissipates from the mist outlet, the water temperature cools rapidly due to the large surface area of each droplet, hence the mist is referred to as a 'cool mist'.

13. Always plug the adaptor into the DC jack before plugging into the mains.

14. Do not remove the covers during operation.

15. NEVER touch the ultrasonic ceramic disc while the diffuser is plugged in as this could cause serious injury.

16. Do not immerse the unit in water or other liquids and do not attempt to clean in a dishwasher.

17. When using the light only mode, the standby mode will not operate. Switch off the light as per the instructions in this manual.



OPERATING INSTRUCTIONS

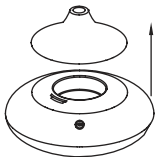

1. Remove the diffusion cone.



2. Fill the tank with clean tap water (max. 80ml)



3. Add 3-5 drops of your favourite fragrance or essential oil into the water.

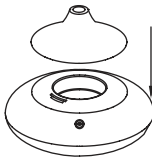

4. Replace the diffusion cone

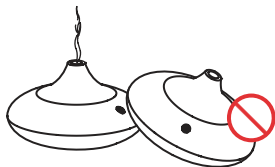
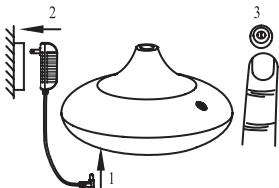

5. Plug the adaptor and press the ① button

Note: Do not lean or move or attempt to empty or refill the diffuser during operation.

USE OF SELECTION SWITCH:

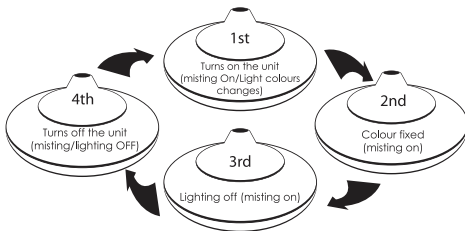



FEATURES

The Soto Ultrasonic Aroma Diffuser provides a revolutionary way to fragrance your surroundings. It works by creating high frequency vibrations that breaks down the water and oil into minute particles which are then effectively diffused into the immediate surroundings.

- Unique patented design
- Low energy LED lights
- Mini humidifier
- Full LED Mood Lighting
- Aroma Diffuser: Can be used with mood lighting or without the light, ideal for night time use
- Auto-shut off when water runs out for an additional safety
- Easy to clean and use

Note: Auto shut off does not operate when using light only mode.



MAINTENANCE

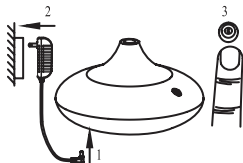

1. Press the ① button to turn off the unit and unplug the adaptor

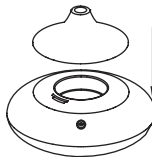

2. Remove the diffusion cone

NOTE: we advise you to empty and rinse the water tank and wipe it dry with a clean cloth every time you use a different type of essential oil



3. Empty water following the water discharge indicator

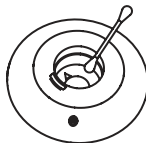

4. Use a damp cloth to clean the exterior of the housing. Use a clean swab or cloth to clean water the tank

Caution: Always switch off the appliance and disconnect the power source from electrical outlet before cleaning.

Always keep your aroma diffuser clean and dry when not in use.

Never leave stagnant oil and water inside the tank for prolonged periods.

For stubborn oil build up, use sanitary alcohol on a cotton bud if required.

If the aroma diffuser does not generate mist (or generates little mist), clean the ceramic disc.

When cleaning, always take extra care to ensure water does not enter DC Jack power port.

Allow the unit to dry thoroughly as advised below if water accidentally enters the electrical port.

Accidental Leakage: In the event of the aroma diffuser being knocked over during use, please follow the steps below to avoid malfunction.

- Unplug the diffuser from the mains and remove the cover carefully.
- Pour out any remaining water from the tank.
- Shake the diffuser gently to drain any water from inside, then leave for 24 hours for the diffuser to dry thoroughly in a well-ventilated area.



TROUBLESHOOTING

Problem	Possible Cause	Solution
No mist or mist volume significantly reduced	Water is lower than the water level sensor	Refill the reservoir with ordinary tap water. Take care not to fill past the max water level line
	Water is exceeding the max water level line	Carefully pour out excess water via the water drain side.
	There may be a build-up of oil on the ceramic disc	Clean the ceramic disc with water and a clean cloth.
	Mist outlet is blocked	Clean the mist outlet by thoroughly cleaning the inside of the cover with clean water.
Unit will not switch on	There is insufficient water in the reservoir	Carefully fill the reservoir with water to the Max Water Level. Do not overfill.
	The Power cable may not be connected properly.	Disconnect the cable and try connecting properly.
Water is leaking from the unit	The cover is not positioned correctly	Remove the cover and replace correctly, allowing the mist to release correctly.
	The unit has been tipped or knocked over	Follow the accidental leakage instructions .
	The temperature is low and/or there is high humidity	Under these conditions, mist can sometimes condense into water droplets.

The intensity and amount of mist may vary, but this is not unusual and should not be considered as a fault. Factors that may affect this include water type, humidity, temperature, air currents etc.



WARRANTY

This product carries a 12-month warranty for proper use in accordance with this manual against any manufacturing defects.

Accidental damage is not covered under the warranty.

The warranty period is 12 months from the date of purchase. In case of any problems arising during the warranty period, please contact your retailer for maintenance or claims.

Proof of purchase will be required, so it is vital that you keep your receipt of purchase with this safety manual.

Corrosive oils such as Citronella may cause damage to the unit if left in the water tank. This type of damage is not covered under the warranty. This Aroma Diffuser must be cleaned after each use.



IMPORTANT!

MADE BY ZEN® Ultrasonic Aroma Diffusers comply with the WEEE Directive (Waste from Electrical and Electronic Equipment Directive) 2012/19/EU.

When the Soto Aroma Diffuser reaches the end of its working life, it should not be disposed of in the normal waste stream, but at an appropriate collection point for the recycling of electrical products.

Caring for our planet is important to us, so please help us by disposing of Soto correctly. Thank you.



MADE BY ZEN®

MADEBYZEN.COM