

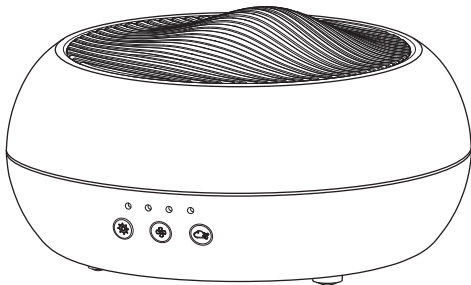

MADE BY ZEN[®]



MYSA

Scandi style Aroma Diffuser with
soothing light and multiple mist settings

TABLE OF CONTENTS:

A. ABOUT THE MYSA

B. TECHNICAL SPECIFICATION

C. OPERATING INSTRUCTIONS

D. FEATURES

E. MAINTENANCE

F. TROUBLESHOOTING

G. WARRANTY

Congratulations on purchasing your MADE BY ZEN® Mysa Aroma Diffuser. Please keep this manual to help you get the most out of your Mysa and for maintenance.

A - ABOUT THE MYSA

Mysa represents being in the moment, enjoying life with all your senses. Named after the Swedish word for cosy, Mysa embodies tranquility and relaxation, releasing a cool scented Aromatherapy mist to fill the air with your favourite scents, whilst making you feel calm and balanced. In a simple Scandi design with an elegant curved cover, Mysa gracefully arches to show the ambient light underneath. Optimise your run time, choose from 1, 2 or 3 hours, it's perfect for moments of mindfulness and serenity throughout the day.



Warm, ambient LED lighting which can help you to relax

- Soft glow, fixed ambient light
- Sleep mode (no light) option



Multiple timer settings, choose from 1 hour, 2 hours, 3 hours



2 mist intensity options: Low/High continuous mist setting



Suitable for use with any essential or fragrance oils (MADE BY ZEN® oils included)

Thank you for purchasing the MADE BY ZEN® Mysa Aroma Diffuser.

B - TECHNICAL SPECIFICATIONS

Model Name: Mysa Aroma Diffuser

Model No: EWX057

Product Size: $\Phi 168 \times 96\text{mm}$

Voltage: DC 24V

Power: 12W

Water Capacity: 250ml

Run Time: 9 hours high mist

12 hours low mist

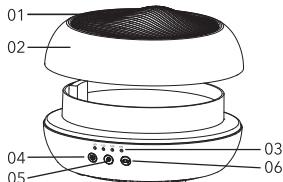

01. Mist Outlet

02. Cover

03. Indication Light

04. Light Button

05. Mist Intensity Button

06. Mist Button

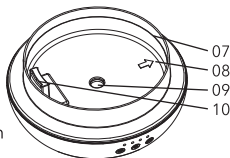

07. Max. Water Level Line

08. Drainage Direction

09. Ceramic Disc

10. Air Outlet

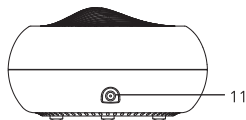

11. DC Jack

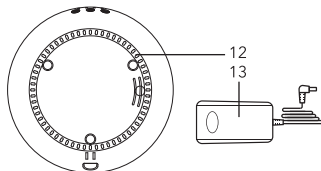

12. Air Inlet

13. Adaptor

IMPORTANT NOTES BEFORE

1. Place the Aroma Diffuser on a flat surface, at least 60cm away from the floor and at least 10cm away from the wall. DO NOT place the Aroma Diffuser on wooden or polished furniture that may be damaged by water moisture.
2. Always unplug the Aroma Diffuser from the mains electrical supply when cleaning or filling with water. Always use the power adaptor supplied. Ensure the cable is secure to avoid tripping or knocking over the Aroma Diffuser. If the power adaptor is damaged, it must be replaced with a suitable adaptor provided by the manufacturer or its agent. Alternatively, a new adaptor can be purchased from your retailer.
3. Use a suitable measuring cup to fill the water into the water tank. Never attempt to fill water under a running tap or whilst plugged in. Do not fill the water beyond the max water level line. If overfilled, carefully remove the excess water from the tank in the 'drainage direction' as shown by the arrow and away from the vent hole.
4. The Aroma Diffuser must be kept out of reach from children and pets to avoid risk of injury. Children should be supervised at all times to ensure they do not play with the appliance.
5. The Aroma Diffuser is not intended for use by persons (including children) with reduced physical, sensory or mental capabilities or lack of experience and knowledge, unless they have been given supervision or instruction concerning use of the appliance by a person responsible for their safety.
6. Keep the Aroma Diffuser in a clear space to allow the mist to freely spread and away from appliances especially those sensitive to water to avoid unnecessary accidents.
7. The Aroma Diffuser must be cleaned after each use and should always be kept clean and dry when not in use. Never leave stagnant oil and water in the water tank for prolonged periods.
8. Never attempt to disassemble your Aroma Diffuser or repair the product, as this will void your warranty and create a shock hazard. Contact your retailer if an internal inspection is required.

9. In case of abnormal observations such as smoke, peculiar smells or noise, stop using the Aroma Diffuser immediately and contact the retailer from where you purchased it. Never wrap the aroma diffuser or adaptor with cloth or paper as blocking ventilation could increase the risk of fire.

10. Always handle the Aroma Diffuser with care – accidental damage is not covered under the warranty.

11. Always use water at room temperature and use only fresh, clean water from a reliable source. Do not fill the water tank with other chemicals or liquids other than water and a few drops of fragrance or essential oils.

12. Never touch the water within the water tank when the diffuser is in operation as the water may become warm. It is perfectly normal for the water temperature to increase over time. Especially if it has been running for a few hours. This is caused by the energy created from the vibrating disc. The water should not exceed 40°C but for some models it can increase to 50°C (+/- 5°C). However, as the mist dissipates from the mist outlet, the water temperature cools rapidly due to the large surface area of each droplet, hence the mist is referred to as a 'cool mist'.

13. Always plug the adaptor into the DC jack before plugging into the mains.

14. Do not remove the cover during operation.

15. NEVER touch the ultrasonic ceramic disc while the diffuser is plugged in as this could cause serious injury.

16. Do not immerse the unit in water or other liquids and do not attempt to clean in a dishwasher.

17. When using the light only mode, the auto shut off mode will not operate. Switch off the light as per the instructions in 'Button Function'

C - OPERATING INSTRUCTIONS



1. Place the diffuser on a firm and flat surface, in upright direction. Remove the cover upwards carefully as shown.

2. Add water to the water tank with a suitable measuring cup until the water reaches the max. water level line.

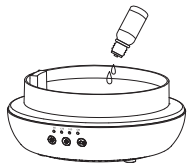

3. Add 3-5 drops of your favourite fragrance or essential oil into the water.



4. Replace the cover.

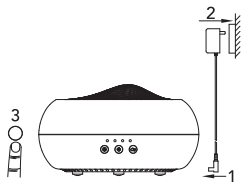

5. Plug the cable into the DC Jack before connecting the USB port to the power supply.

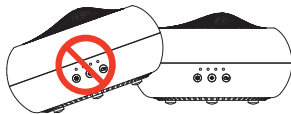

Note: Do not lean or move or attempt to empty or refill the diffuser during operation.

BUTTON FUNCTIONS



LIGHT CONTROL (LEFT BUTTON)

> Press  once to switch on the ambient light function.

> Press  twice to switch off the ambient light function.

Please note that the mist and light modes operate independently. This allows you to switch off the light whilst the unit is still misting; ideal for night time use.

Please note the auto-shut off will only operate when the mist function is being used. During the light only mode, you will have to manually switch off the light by pressing the  button twice.

MIST CONTROL (RIGHT BUTTON)

> Press  once the Aroma Diffuser will mist continuously for 1 hour until the water level runs low.

The '60' indication light indicator will be lit.

> Press  twice the Aroma Diffuser will mist continuously for 2 hours until the water level runs low.

The '120' indication light indicator will be lit.

> Press  three times the Aroma Diffuser will mist continuously for 3 hours until the water level runs low.

The '180' indication light indicator will be lit.

> Press  four times the Aroma Diffuser will mist continuously until the water level runs low.

The 'ON' indication light indicator will be lit.

> Press  five times to turn off the mist mode.

Note: When the water level runs low the Aroma Diffuser will automatically switch off. Press and hold for 3 seconds at any point to turn the mist function off.

MIST INTENSITY (MIDDLE BUTTON)

(This button will only activate after switching on the mist mode using the  button)

> Press  once for high mist, when pressed 1 beep will sound.

> Press  twice for low mist, when pressed 2 beeps will sound.

Note: To turn off the mist function follow mist control section.

D - FEATURES

The Mysa Ultrasonic Aroma Diffuser provides a revolutionary way to fragrance your surroundings. It works by creating high frequency vibrations that breaks down the water and oil into minute particles which are then effectively diffused into the immediate surroundings.

- Aroma Diffuser: Can be used with ambient lighting or without the light, ideal for night time use
- Low energy LED lights
- Mini humidifier
- Quiet operation
- Auto-shut off when water runs out for an additional safety
- Easy to clean and use

Note: Auto shut off does not operate when using light only mode.

E - MAINTENANCE

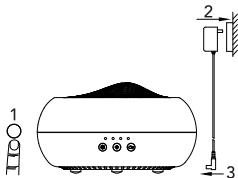

1. Make sure the light and mist functions have been switched off and unplug the power from the mains.

DO NOT EMPTY WATER FROM THE SIDE OF THE AIR INLET AS WATER MAY ENTER INTO THE UNIT.

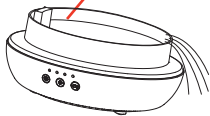

3. Empty water via the water drainage side, as shown by the arrow at the base of the water tank



2. Remove the cover.

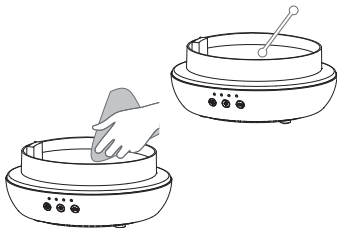

4. Use a clean swab or cloth to clean the unit

Caution: Always switch off the appliance and disconnect the power source from electrical outlet before cleaning.

Always keep your Aroma Diffuser clean and dry when not in use.

Never leave stagnant oil and water inside the tank for prolonged periods. If the aroma diffuser stops generating mist (or generates little mist), clean the ceramic disc as indicated above. For stubborn oil build up, use sanitary alcohol on a cotton bud if required.

For stubborn oil build up, use sanitary alcohol on a cotton bud if required. If the Aroma Diffuser does not generate mist (or generates little mist), clean the ceramic disc.

When cleaning, always take extra care to ensure water does not enter DC Jack power port. Allow the unit to dry thoroughly as advised below if water accidentally enters the electrical port.

Accidental Leakage: In the event of the aroma diffuser being knocked over during use, please follow the steps below to avoid malfunction.

- Unplug the diffuser from the mains and remove the cover carefully.
- Pour out any remaining water from the tank.
- Shake the diffuser gently to drain any water from inside, then leave for 24 hours for the diffuser to dry thoroughly in a well-ventilated area.

F - TROUBLESHOOTING

Problem	Possible Cause	Solution
No Mist or mist volume significantly reduced	Power supply is not connected	Plug in the power adaptor and press the mist button
	Water is lower than the water level sensor	Refill the tank with ordinary tap water. Take care not to fill past the max water level line
	Water is exceeding the max water level line	Carefully pour out excess water in the direction of the water discharge arrow
	There may be a build-up of oil on the ceramic disc	Clean the ceramic disc with water and a clean cloth
	Mist outlet is blocked	Clean the mist outlet by thoroughly cleaning the inside of the cover with clean water
Unit will not switch on	There is an insufficient amount of water in the tank	Fill the water tank with water up to the max water level line. Do not over fill
	The Power cable may not be connected properly	Disconnect the cable and try connecting properly
Water is leaking from the product	The cover is not positioned correctly	Remove cover and replace correctly allowing mist to release correctly
	The unit has been tipped or knocked over	Follow the accidental leakage instructions
	The temperature is low or there is high humidity	Under these conditions the mist can sometimes condense into water droplets
	Water moisture has built up inside the cover	Remove the inner cover and dry off excess water from the inside of the cover

The intensity and amount of mist may vary, but this is not unusual and should not be considered as a fault. Factors that may affect this include water type, humidity, temperature, air currents etc.

G - WARRANTY

This product carries a 12-month warranty for proper use in accordance with this manual against any manufacturing defects. Accidental damage is not covered under the warranty.

The warranty period is 12 months from the date of purchase. In case of any problems arising during the warranty period, please contact your retailer for maintenance or claims. Proof of purchase will be required, so it is vital that you keep your receipt of purchase with this safety manual.

Corrosive oils such as Citronella may cause damage to the unit if left in the water tank. This type of damage is not covered under the warranty. This Aroma Diffuser must be cleaned after each use.



IMPORTANT!

MADE BY ZEN® Ultrasonic Aroma Diffusers comply with the WEEE Directive (Waste from Electrical and Electronic Equipment Directive) 2012/19/EU.

When the Mysa Aroma Diffuser reaches the end of its working life, it should not be disposed of in the normal waste stream, but at an appropriate collection point for the recycling of electrical products.

Caring for our planet is important to us, so please help us by disposing of Mysa correctly. Thank you.



MADE BY ZEN®

MADEBYZEN.COM