

# User manual for InnoGIO Silicone night light

**GIO-137**

## GIOrabbit Maxi

### Basic Information

Item name: InnoGIO Silicone night light GIOrabbit Maxi  
 Item Size: 134 x 140 x 299 mm  
 Item No.: GIO-137  
 Working voltage/current: 5 V --- 1000 mA  
 Power: 1 W  
 Battery capacity: 1200 mAh  
 Accessory: Type-C USB Cable, Remote control  
 Material: Silicone  
 Function: Lamp, illumination

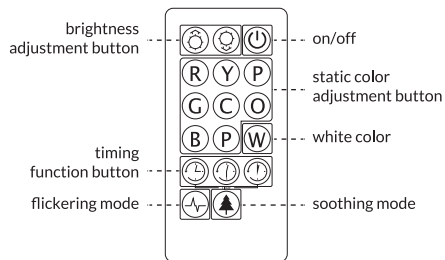
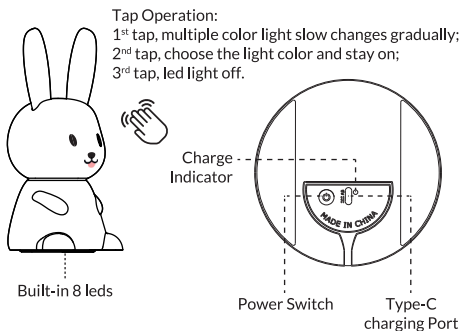

REMOTE CONTROL OPERATION (USED WHEN THE POWER SWITCH IS ON)	
THE FUNCTION BUTTON	SPECIFIC OPERATION
Brightness Adjustment Button	Press "☀" to increase brightness, press "☾" to reduce brightness
On/Off	With the lights on, press "⏻" to turn off the lights
Static Color Adjustment button	Static color settings, press select color you want
White Color	Press "⊙" to reset the static color to warm white light
Timing function button	Press "⌚" the red light flashes, start the timing for 15 mins; Press "⌚" the red light flashes, start the timing for 30 mins; Press "⌚" the red light flashes, start the timing for 1 hour
Flickering Mode	Press "⚡" to turn on the Flickering Mode
Soothing Mode	Press "🌲" to turn on the Soothing Mode

### Features

1. This product is a rechargeable lamp, which can be recharged for use.
2. This lamp has different colorful lights and can be adjusted as you wish.
3. This lamp is made of soft silicone and has lovely shape, thanks to which it can also be used as a decoration.

### Instructions for use

1. Please fully charge the product before first its use. Charging voltage / current DC5V --- 1000 mA. It will take about 3 hours to fully charge the product. While charging, the red indicator light flashes; once fully charged, the red indicator light will remain on.
2. Working time when fully charged is 12H-24H.
3. Power Switch: press it to turn on warm white light; press again to turn off.
4. Tap to change led colors: the LED color will be multicolor after the first tap (the light color will be changing over time); tap again, the light color will remain on; tap for a third time, the light will turn off.
5. You can tap the lamp to change color or alternatively use the remote control to adjust the light brightness and color. When the power switch is on, follow the function instructions of the remote control. (The range of the remote control is 5 meters)
6. Timing function: Press "⌚" the red light flashes, start the timing loop for 15 mins; "⌚" the red light flashes, start the timing loop for 30mins; "⌚" the red light flashes, start the timing loop for 1 hour; Press the power button to turn off the light.

7. When the light is turned off by tapping, the product is still working and static current is generated. If the lamp will not be used for a long time, turn off the light with the power switch to reduce the loss of the battery.
8. After the lamp is fully charged, unplug the charger.
9. Do not use more than 5V --- 2000 mA quick charge.

### Attention ⚠

1. Children under six should use this product only under adults supervision.
2. Do not disassemble the internal device to avoid damaging the components.
3. When the product is not used for a long time, place it in a dry environment
4. The light source in this lamp must be replaced by the manufacturer or his service agent or a similarly qualified person.
5. To prevent the lamp falling over, place it on a table with a slope not exceeding 6 degrees.

innoGIO

Produced in China for INNOGIO sp. z o.o.  
 Ostródzka street 74H, 03-289 Warsaw, Poland  
[www.innogio.com](http://www.innogio.com)  
 Date of issue: 6/2021

@innoGIO.official @innogio\_com

