



Occean Air2T Sonic Electric Toothbrush User Manual



www.occean.com

Thank you for using Occean Air2 Sonic Electric Toothbrush.

Important Safety Tips:

Due to the high-speed vibrations, it is normal to experience a tingling sensation while using the toothbrush for the first time. This feeling will gradually go away after 7 to 14 days.

If the toothbrush is not used for a long time, the battery will run out due to the power consumption from standby mode. This can be solved by charging, but the charging indicator on the brush will not light up instantly. Please wait for 6 - 10 minutes for the toothbrush to go back to the normal state.

It is normal for the toothbrush to heat up when it is charging. If the toothbrush becomes extremely hot, immediately stop charging and/or turn it off and send it to Occean's authorized customer service center for checking.

The toothbrush can only be used with the Occean's brush heads. Occean will not be able to take any consequences caused by non-official brush head.

The toothbrush is for oral cleaning only. Please do not use it for other purposes.

The toothbrush is a personal cleaning item, please avoid sharing it with others.

Please store the toothbrush in a cool and ventilate place, and avoid directly expose to sunlight.

Caution for Oral Sensitive Person:

The following 3 types of people are not recommended to use this toothbrush unless you have already consulted the professional dentists.

1. Person who has undergone or is under treatment for periodontal surgery.
2. Person with poor fitting dentures, continuously bleeding gums or any other oral related symptoms.
3. Person whose oral is sensitive.

Unless under the provision of guardian, this toothbrush is not suitable for people with reduced mental and physical capabilities, and those who lack related experience, and children under the age of 12.

Notes:

Please shut off the power when the charging base is needless or before cleaning.

Please regularly clean the power plug to prevent the accumulation of dust and dirt which can reduce the charging effect.

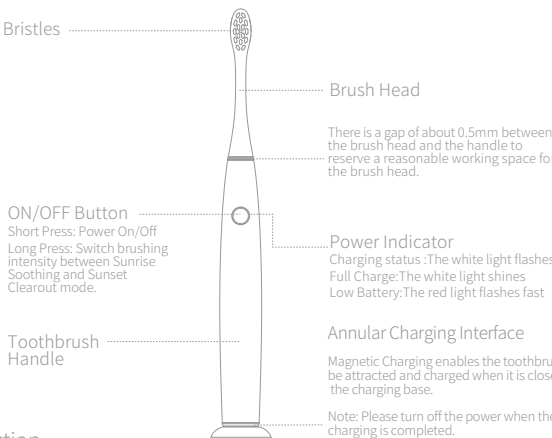

Interaction Introduction

Power On

Start the toothbrush by short pressing the power button, the toothbrush will automatically shut down after a 2-mins brushing section is finished.

Intensity Switch

Occean Air2 has 2 types of 2mins brushing plan: Sunrise Soothing(Default) and Sunset Clearout mode. To switch between intensities, just long press the power button for 2s under working condition.

Battery Indication

Please charge the toothbrush when the red indicator light is on.

Using Instructions

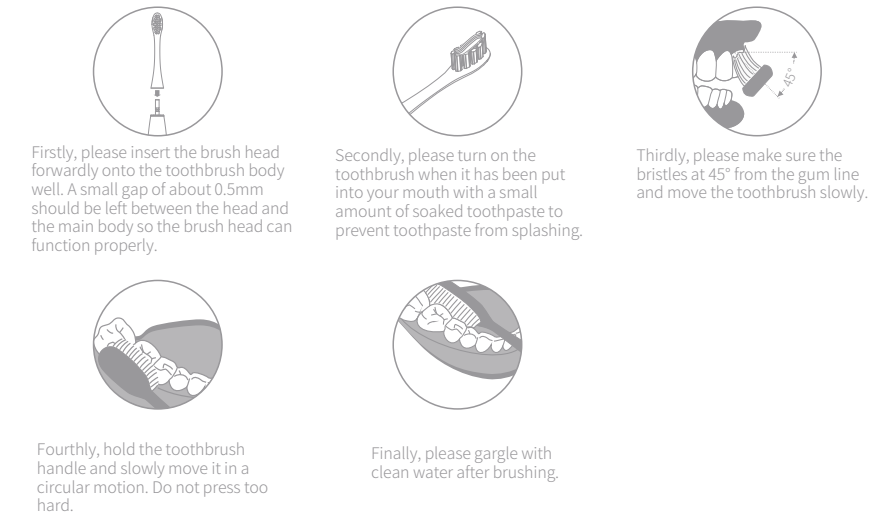

Recommended Tooth Brushing Method

Brushing Time

Oral experts (Dentists) recommended that each brushing should be 2 to 3 minutes long.

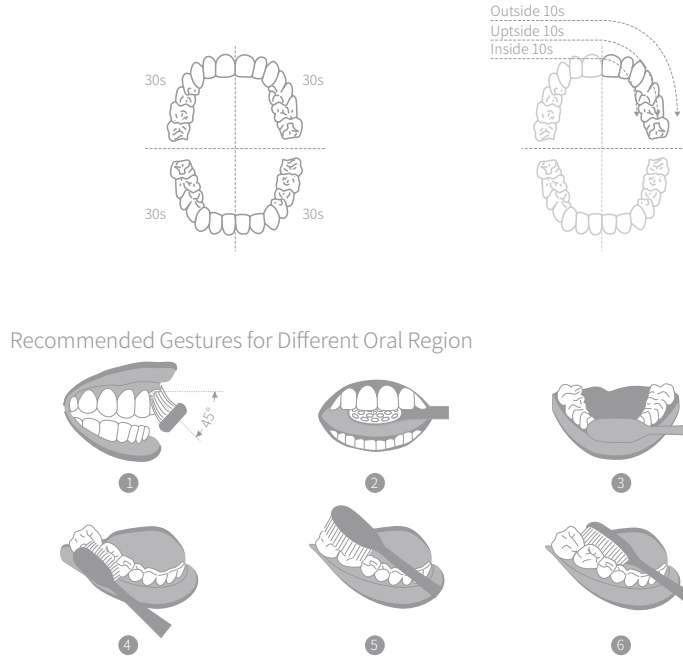

Recommended Gestures for Different Oral Region

Charging Process

0%-95%, the power indicator light flashes.
95%-100%, the Power Indicator light is constantly on.

First Time Use

Charging time depends on the battery usage of user.

Working Process

If battery power is less than 5%, the red indicator light will flash as a charging reminder.

Notes:

The battery cannot be replaced by users themselves and can only be replaced by the staff in Occean Authorized Client Center. Unauthorized bodies are forbidden to disassemble this product. The USB cable cannot be replaced by unauthorized body. If the product was damaged, please contact the Occean's authorized customer service center for maintenance.

Please use the USB charger of 5V/1A or 5V/2A of mobile phone to charge. Such as the iPhone Charger, Tablet Charger etc. If the charge current is less than 1 A, it may prolong the charging time. If the charger voltage is higher than 5V, it may damage the charging circuit.

Cleaning and Maintenance

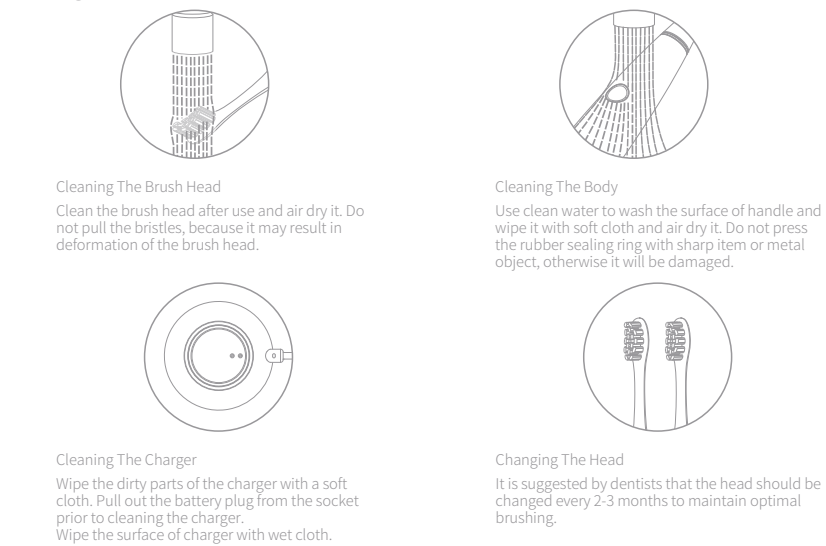

Specifications

Product Name	Occean Air2T Sonic Electric Toothbrush
Model Name	Occean Air2
Input Power	2.5W
Charging	Occean USB Charger
Input	5V=0.5A
Charging Standard	DC 5V/1A or above
Battery Life	30 Days (*)
Battery Capacity	800 mAh (**)
Charging Time	2.5 Hours (***)
Standard	GB 39669-2020

* Validated by 2 minutes brushing period, twice a day with low intensity mode.

** The battery capacity theoretically has a capacity range of ±50mAh.

*** It is suggested to use a USB charger of 5V/0.5A.

Common Problems and Solutions

The following are some common problems the users can face while using the toothbrush.

These problems can be easily solved by the users with the solutions given below. Please conduct the following trouble shooting techniques prior to contacting professional after-sale services.

1.The vibration strength becomes weak

Possible Problems:

The toothbrush is pressed too hard against the tooth.

The gap between the brush head and body is too loose or too tight.

Solutions:

Lightly place the brush head on tooth. Pull the brush head from the body or gently insert the brush head leaving enough space between the brush head and body.

2.The toothbrush functioning for short time

Possible Problems:

The charging cradle is not in contacted with the charging ring of the body, and may have resulted in improper charging which can also be detected by the LED light.

Insufficient battery charge.

Solutions:

Clean the charger cradle.

Charge for longer period.

Battery has completed its service life.If the red light of the foundation is on, please contact the Occean Official Authorized Center for a replacement charger.

3.The product is unable to work

Possible Problem:

Insufficient battery power.

Solutions:

Please charge the toothbrush

Please contact Occean Official Support Center for a replacement battery if the first way doesn't help.

For detailed consultations, Email: service@occean.com

FCC WARNING

This device complies with part 15 of the FCC Rules. Operation is subject to the following two conditions: (1) this device may not cause harmful interference, and (2) this device must accept any interference received, including interference that may cause undesired operation.

Any changes or modifications not expressly approved by the party responsible for compliance could void the user's authority to operate the equipment.

NOTE: This equipment has been tested and found to comply with the limits for a Class B digital device, pursuant to Part 15 of the FCC Rules. These limits are designed to provide reasonable protection against harmful interference in a residential installation. This equipment generates, uses and can radiate radio frequency energy and, if not installed and used in accordance with the instructions, may cause harmful interference to radio communications. However, there is no guarantee that interference will not occur in a particular installation.

If this equipment does cause harmful interference to radio or television reception,

which can be determined by turning the equipment off and on, the user is encouraged to try to correct the interference by one or more of the following measures:

— Reorient or relocate the receiving antenna.

— Increase the separation between the equipment and receiver.

— Connect the equipment into an outlet on a circuit different from that to which the receiver is connected.

— Consult the dealer or an experienced radio/TV technician for help.

The device has been evaluated to meet general RF exposure requirement. The device can be used in portable exposure condition without restriction.

EU REP	EU Authorized Representative Agency name: Miroslav UAB Representative: Algirdas Tevelis	European Address: Totorių g.3, Kaunas, Lithuania Post Code: LT44237	Email: service@mobalt.eu Phone: +37067052772
--------	---	---	---

Guarantee Certificate of Occean Air2T Sonic Electric Toothbrush

User Information

Name: _____ Phone: _____ E-mail: _____ ZIP code: _____

Retailer Information

Retailer: _____ Phone: _____ Address: _____

Product Information

Sales date: _____ ZIP code: _____ Invoice no.: _____

Product Information

Product type: _____ Manufacturing site: _____

Warranty Card of Occean Air2T Sonic Electric Toothbrush

Delivery date	Fault description/reason/disposal	Equipment employed	Acceptance date	Serviceman

Please request a maintenance report from the maintenance center and keep it together with the warranty certificate (See the page on the left.)

Shenzhen Yunding Information Technology Co., Ltd., in strict accordance with the Responsibility Regulations on Maintenance, Replacement and Sales Return of Household Appliances, offers a guarantee for consumers who purchase the Occean Smart Sonic Electric Toothbrush. In the case of any inconsistency between the service articles and the provisions of guarantee, the provisions of the guarantee and the contents of the guarantee certificate shall govern. If the product you have purchased is found to have a fault or defect, please contact our service line at 4008-365-909.

Manufacturer: Shenzhen Yunding Information Technology Co., Ltd.
Manufacturer's address: 28G, Building 3, Dachong Business Center (phase III), No.18 Dachong 1st Road, Dachong Community, Yuehai Street,Nanshan District, Shenzhen, Guangdong, China.
Production address: No.89, Dingphan Middle Road, Dongfu Street, Haicang District, Xiamen, Fujian, China
Made in China
Website: www.occean.com

Name of parts	Toxic and harmful substance or element							Environment Protection
	Pb	Hg	Cd	Cr6+	PBBs	PBDEs	4 Phthalates	
PCBA	○	○	○	○	○	○	○	10 years
Plastic parts	○	○	○	○	○	○	○	
Metal hardware	○	○	○	○	○	○	○	

Name of parts	Toxic and harmful substance or element							Environment Protection
	Pb	Hg	Cd	Cr6+	PBBs	PBDEs	4 Phthalates	
Vibrating motor	○	○	○	○	○	○	○	10 years
Accessories	○	○	○	○	○	○	○	
Battery	○	○	○	---	---	---	---	

Remarks

○ This indicates that the content of toxic and hazardous substances in all homogeneous materials of this component is less than the limited quantity as specified in RoHS 2.0 Directive: 2011/65/EU & (EU) 2015/863. This indicates that the content of toxic and hazardous substances in at least one of the homogeneous materials of this component is more than the limited quantity as specified in RoHS 2.0 Directive: 2011/65/EU & (EU) 2015/863.

Refer to battery Directive: 2006 / 66 / EC and amendment 2013 / 56 / EU

--- Except for very few materials, due to technical development reasons, most of the materials used are environmentally friendly. Please use this product with confidence during the environmental protection period.



A2T-用户手册-英文

- 1.成型尺寸:135*200mm
- 2.材质:150g哑粉纸 三折页 过哑油;
- 3.裁切整齐无毛边;
- 4.双面印刷 PANTONECoolGray 8C 色彩准确,无套印不准等现象;
- 5.其他要求:产品需满足REACH法规及最新RoHS指令要求。
产品需满足欧可林《包装材料来料检验通用标准》。
- 6.公差:±1mm
- 7.标注单位mm