

Makeup Mirror with LED Lights

Instructions for use

Dear Customer

We at CARL&SON are honored that you have chosen to buy our high-quality makeup mirror. It will give you an improved experience and better results when you treat and makeup your face. Your new makeup mirror is equipped with 16 bright LED lights that ensure the best possible lighting. The practical touch screen allows you to turn the lights on and off, as well as smoothly adjust the brightness.

We at CARL&SON hope you will enjoy your new makeup mirror with LED lights!

Technical specifications

Model: SK1603A Batteries: 4x LR06/AA 1.5 V (not included) Ambient temperature: +10 to +40 °C	
--	--

Made for:

Carl&Son with Friends AB, Box 150 23, 200 31 Malmö, Sweden
www.carlandson.com

In the course of product improvement, we reserve the right to make technical and optical modifications to the product.



Safety warnings

In order to avoid accidental injury or damage, please read the safety warnings carefully and only use the product as described in this product manual. Keep this product manual for future reference. If you give this product to another person, remember to also include this manual. This product is designed for indoor use. It is designed for home use and is not suitable for commercial purposes.

- Keep packaging material away from children. There is a risk of suffocation!
- Swallowing batteries can be fatal. If a battery is swallowed, it can cause severe internal chemical burns and even death within 2 hours. Therefore, keep both new and old

batteries and the product out of the reach of children. If you think that a battery has been swallowed or has got into the body in any other way, seek medical advice immediately.

- If a battery leaks, avoid contact with skin, eyes and mucous membranes. If necessary, rinse the affected areas with plenty of water and consult a doctor immediately.
- Do not charge single-use batteries. Batteries must not be taken apart, thrown into fire or short-circuited. Protect the batteries from excessive heat (radiators, direct sunlight, etc.).
- Remove the batteries from the product if they are flat or if you do not intend to use the product for a longer time. This will prevent damage caused by leakage from the batteries.
- Always replace all batteries at the same time. Do not mix old and new batteries, different types or brands of batteries, or batteries with different capacities.
- If necessary, clean the contacts on the batteries and product before inserting the batteries. Danger of overheating!
- Ensure that the polarity (+/-) is correct when inserting batteries.
- Protect the product from dust, moisture, direct sunlight and extreme temperatures.
- Do not use any caustic, aggressive or abrasive products for cleaning.
- The built-in LED lights cannot, and must not be, replaced.
- Set up the product in a place where it cannot fall or be knocked over. Risk of injury due to broken glass.

Product overview

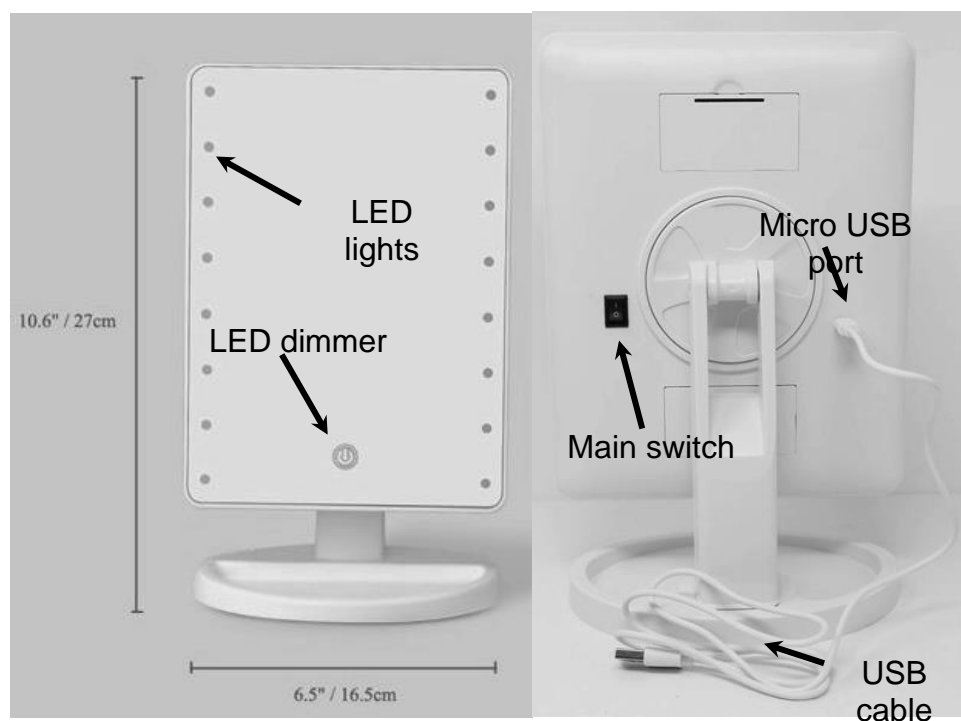

Prior to first use

Assembly

1. Carefully remove all packing material.
2. Place the stand of the makeup mirror into the slot in the base of the makeup mirror and push it in until you hear and feel it lock into place.

The LED lights can be powered through the USB cable or through batteries. Batteries can be placed in the mirror while the USB cable is connected to a power outlet. While the USB cable is connected to a power outlet, rechargeable batteries will NOT be charged.

To power the LED lights with USB cable:

3. Plug the USB cable into the micro USB port on the back of the mirror.
4. Plug the USB of the cable into an USB power source.

To power the LED lights with batteries:

5. Remove the battery compartment lid.
6. Insert the batteries. Ensure that the polarity is correct (+/-).

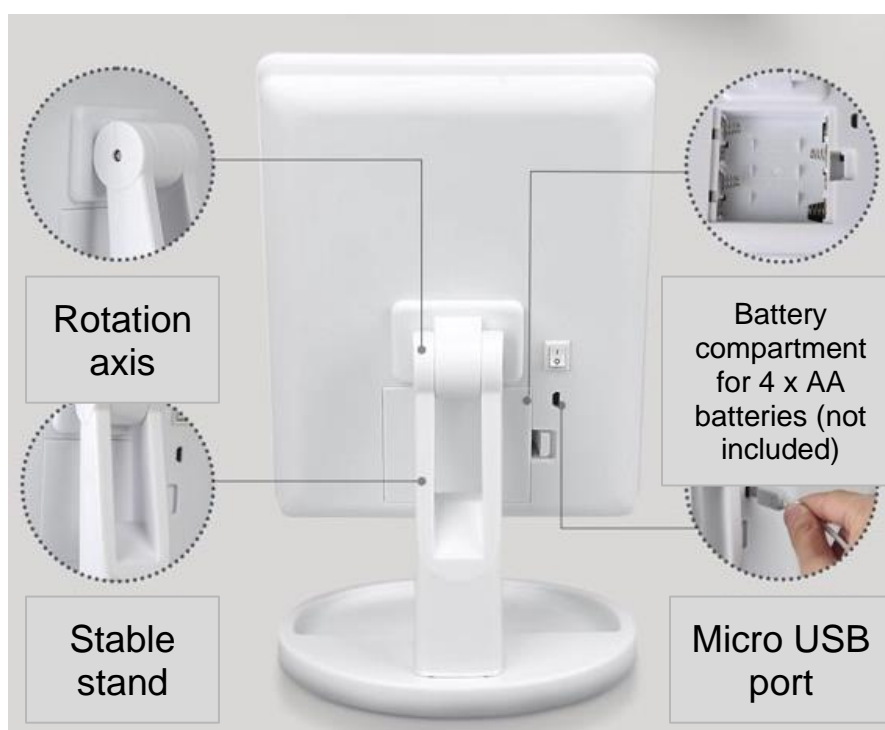

7. Reattach the battery compartment lid and push the lid until you hear and feel it lock into place.

Use

Switching on the LED lights

1. To turn the mirror on, flip the main switch on the back of the mirror to 1.
2. To turn the LEDs on, tap the On/Off switch on the mirror front surface.

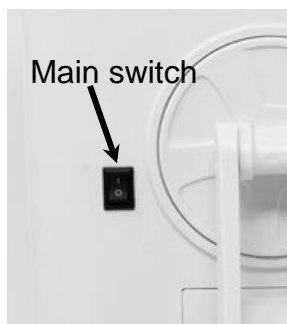

Dimming the LED lights

- Press the On/Off switch on the mirror front surface and hold it down until you have reached your preferred brightness. The LED lights are dimmed.
- Press the On/Off switch on the mirror surface once again and hold it down. The LED lights become brighter.
- If you turn the LEDs off and then on again, the LED lights will light up to full brightness.

Switching off

1. To turn the LED lights off, tap the On/Off switch on the mirror surface.

The LEDs will light up to full brightness the next time they are turned on.

2. To turn the mirror off, flip the main switch on the back of the mirror to **O**.

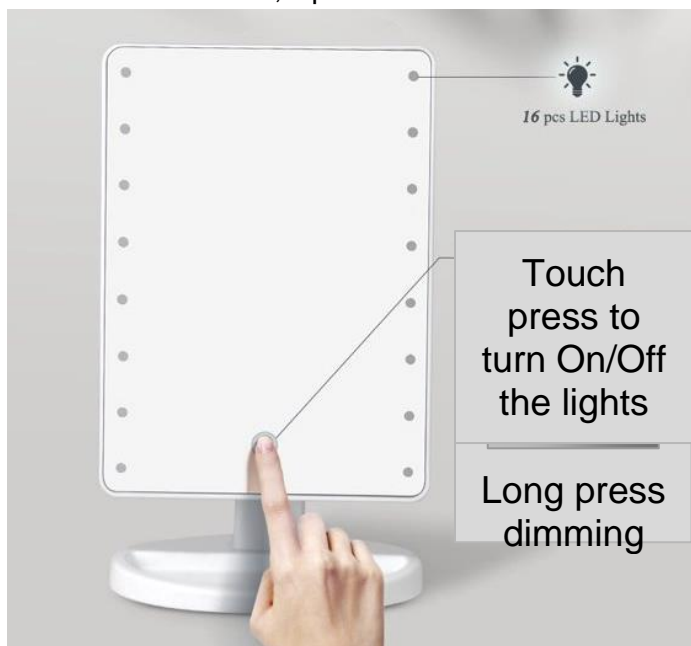

Cleaning and maintenance

- The front and back of the mirror is recommended to be cleaned with a damp soft cleaning cloth. A very gentle detergent can be used to dampen the cleaning cloth.
- Cleaning of the mirror should NOT be done with liquids or pastes that contain strong acids, ammonia, chlorine, or other abrasive components.
- The electrical switch, the micro USB port and the battery compartment on the back of the mirror should NEVER come in contact with any moisture.

- To avoid stains after cleaning with a damp cleaning cloth, dry the surfaces with a soft clean cloth.

Disposal

This product and its packaging have been manufactured from valuable materials that can be recycled. Recycling reduces the amount of refuse and helps to preserve the environment.

Dispose the packaging at a recycling point that sorts materials by type. Make use of the local facilities provided for collecting paper, cardboard and light-weight packaging.

- The outer box is recycled as cardboard
- The inner plastic bag is recycled as light-weight packaging or plastic
- The mirror and the cable are electrical devices. You are legally obliged to discard old electrical devices separately from household waste. Local authorities can provide information where old electrical devices can be discarded.
- Single-use batteries and rechargeable batteries must NOT be discarded with household waste. You are legally obliged to discard all flat batteries at a local authority collection point or to return them to a battery retailer.