

FOREO
SWEDEN

My
Smart
choice



LUNA™ play smart 2

SMART SKIN ANALYSIS & FACIAL CLEANSING DEVICE



ONLINE MANUAL

FULL USER MANUAL

GETTING STARTED

Congratulations on taking the first step toward discovering smarter skincare by acquiring LUNA™ play smart 2. Before you begin to enjoy all the benefits of sophisticated skincare technology in the comfort of your home, please take a few moments to carefully read the instructions in this manual.

Please **READ ALL INSTRUCTIONS BEFORE USE** and utilize this product only for its intended use as described in this manual.

⚠ WARNING: No modification of this equipment is allowed.

LUNA™ play smart 2 OVERVIEW

Experience the world's most intelligent 360° facial cleansing device - LUNA™ play smart 2! Made entirely of ultra-soft silicone that is 35x more hygienic than nylon bristles, this palm-sized 2-in-1 personal beauty coach features smart skin sensors that measure and analyze your skin's moisture level on each area of the face, and then creates a completely customized cleansing routine for you based on the results. Featuring 8,000 T-Sonic™ pulsations per minute that remove up to 99.5% of dirt, oil, sweat and makeup residue with a gently exfoliating massage, facial cleansing has never been more fun, effective and easy!

GETTING TO KNOW LUNA™ play smart 2

THICKER TOUCHPOINTS

Increased curvature and thickness provides a deep cleanse for problematic areas such as the T-zone, and more precise cleansing for harder to reach areas.

THINNER TOUCHPOINTS

Ultra-soft and gentle to deeply yet delicately cleanse normal and sensitive skin types, including larger areas such as the cheeks.

T-SONIC™ PULSATIONS

8,000 T-Sonic™ pulsations per minute for deep and effective cleansing and relaxing facial massage.

ULTRA-HYGIENIC SILICONE

Silky soft, quick-drying and nonporous to prevent bacteria buildup, 35x more hygienic than nylon bristles, and suitable for all skin types.

GOLD PLATED SKIN SENSORS

Measures skin at a rate of 1,000 times per second, and analyzes moisture levels in each face zone areas such as the cheeks.

INDICATOR LIGHT

Flashes to indicate when device is in Bluetooth pairing mode, and when device needs to be charged.

UNIVERSAL BUTTON

Turns the device on /off with one press.



UNLOCK YOUR DEVICE

Before first use, download the FOREO For You mobile app to unlock and register your device. Follow these simple steps;

1. Download the FOREO For You app on your mobile phone
2. Log in to your account or sign up for a new one
3. Add device (on the top of your screen)
4. Choose device series
5. Press and hold the Power button to connect your device to the mobile app
6. Fill in the purchase information

And your device is ready to use!

www.foreo.com/app



FOREO FOR YOU MOBILE APP

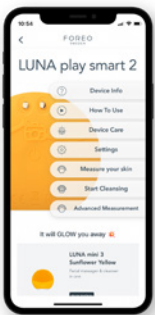

FOREO For You mobile app offers instructions on how to use and take care of your LUNA™ play smart 2, control settings, measure your skin moisture levels, and find your device in case you've misplaced it.



SETTINGS

Set your cleansing preferences and device will remember them for offline use;

Adjust the cleansing duration up to 240s and up to 10 intensities of T-Sonic™ pulsations, separately for each quadrant of your face - both cheeks, forehead, and jawline.



MEASURE YOUR SKIN

This feature is great for quick and easy measurement - simply press and hold the skin sensors on the back of the device to start measuring. After 10 seconds App will show your skin moisture levels and automatically create your personalized cleansing routine which can be saved to your device for your next cleanse.



ADVANCED MEASUREMENT

Advanced measurement allows you to receive a more in-depth analysis of your skin's moisture levels with measurement of 4 areas of your face- both cheeks, forehead, and jawline.

Press and hold the skin sensors for 10 seconds on each face area. When the app indicates, proceed to the next area. The App will show your skin moisture levels and automatically create your personalized cleansing routine which can be saved to your device for your next cleanse.

Start Cleansing features the Mirror mode, which allows you to use your mobile device as a mirror while performing the cleansing.

HOW TO USE

STEP 1: CLEANSE

To prep your skin for the most accurate skin analysis, first cleanse with LUNA™ play smart 2 to remove all dirt and bacteria from the skin to reveal its natural moisture level. After conducting your skin analysis, the FOREO For You app will proceed to sync a customized cleansing routine to your device for your next cleanse.

1. Dampen your skin and apply your regular face cleanser. Then dampen the device.
2. Cleanse using gentle circular movements on cheeks and forehead, gliding up and down the nose. LUNA™ play smart 2 will pause to tell you when to move to the next area of your face.
3. Rinse and pat your face dry. Wait an additional 2 minutes for your face to fully dry and then conduct your skin analysis. Afterwards, apply any other skincare products, as desired.



STEP 2: SKIN ANALYSIS



1. Open the FOREO For You app on your mobile device and turn on Bluetooth.
2. Turn on LUNA™ play smart 2 by holding the universal button until the light starts blinking. Now Bluetooth is connected and your device is ready to begin a smart skin analysis.
3. Press and hold the skin sensors on the back of the device to your cheeks, forehead, side of nose, and chin. When the app indicates, proceed to the next area.
- 4 The FOREO For You app will then analyze the moisture index of your skin, and instantaneously sync a customized cleansing routine to your device. Press and hold the universal button for 3 seconds to turn off device.

For best results, take your skin reading once a week at the same time of day, or when traveling to a new environment.

CLEANING YOUR DEVICE

Always clean your device thoroughly after use. Wash the brush surface with water and soap, then rinse with warm water. Avoid using clay-based, silicone-based or grainy cleansers, exfoliators or scrubs, as they may damage the device's soft silicone touchpoints. Pat dry with a lint-free cloth or towel. After use, we recommend spraying the device with FOREO Silicone Cleaning Spray and rinsing with warm water for optimal results.

NOTE: Never use cleaning products containing alcohol, petrol or acetone, as they may irritate the skin and damage the silicone.

COMPLEMENTARY PRODUCTS



Micro-Foam Cleanser

This creamy cleanser transforms into delicate micro-bubbles that lift impurities from deep within pores, gently purify skin, and remove excess oil. Its special formula, containing skin-replenishing amino acids and vitamin E, helps moisturize and protect your skin so it's left feeling soft and looking vibrant.

DERMATOLOGIST TESTED - FRAGRANCE-FREE - VEGAN - CRUELTY-FREE

IMPORTANT FOR OPTIMUM SAFETY:

- If you have a skin condition or any medical concerns, please consult a dermatologist before use.
- Cleansing with LUNA™ play smart 2 should be comfortable – if you experience discomfort, discontinue use immediately and consult a physician.
- Exercise particular care when cleansing the under-eye regions and do not bring the device into contact with the eyelids or eyes themselves.
- For reasons of hygiene, we do not recommend sharing your device with anyone else.
- Avoid leaving your device in direct sunlight and never expose it to extreme heat or boiling water.
- Close supervision is necessary when this device is used by, on, or near children, as well as those with reduced physical and mental abilities.
- Discontinue use if this product appears damaged in any way. This product contains no serviceable parts.
- Given the efficiency of the FOREO cleansing routine, we recommend that you do not use LUNA™ play smart 2 for more than 3 minutes at a time.
- Use this device only for its intended use as described in this manual. If you do not find the answer to your specific question, or if you have any other questions regarding the device's operation, please visit www.foreo.com

TROUBLESHOOTING

Precautions to be taken in the event of changes in the performance of LUNA™ play smart 2.

If LUNA™ play smart 2 is not activated when pressing the universal button:

- Battery is empty.

If LUNA™ play smart 2 cannot be switched off and/or interface buttons do not respond:

- Microprocessor is temporarily malfunctioning. Press and hold the universal button to restart the device.

If LUNA™ play smart 2 is not picking up your skin during the skin analysis:

- Make sure the device is completely dry and then restart the device.
- Be sure to firmly press both sensors flat on skin.

If LUNA™ play smart 2 won't sync to the FOREO For You app:

- Ensure that your device is fully charged and that your Bluetooth is turned on.
- Switch your Bluetooth off and then on again to try reconnecting.
- Close the FOREO app and then reopen it to start the process over.
- Delete and reinstall the application - perhaps the application simply needs to be updated.
- After deleting and reinstalling the application, make sure to restart your phone.
- Delete your phone's cookies and cache memory
- Ensure that your mobile's operating system has been updated to the latest version.

DISPOSAL INFORMATION

Disposal of old electronic equipment (applicable in the EU and other European countries with separate waste collection systems).



The crossed-out dustbin symbol indicates that this device should not be treated as household waste, but rather be brought to the appropriate collection point for recycling of electrical and electronic equipment. By ensuring this device is disposed of correctly, you will help prevent the potential negative consequences for the environment and human health which could be caused by inappropriate waste handling of the product. The recycling of materials will also help conserve natural resources.

For more information about the recycling of your device, please contact your local household waste disposal service or your place of purchase.

BATTERY REMOVAL

NOTE: This action must only be undertaken when the device is ready to be disposed of.

This device contains 2 batteries, which must be removed before disposal and should not be thrown away with household waste. To remove the batteries, unscrew the battery cover on the base of the product. Then carefully remove the batteries inside.

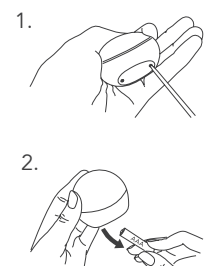

SPECIFICATIONS

MATERIALS:	Body-safe silicone, PC + ABS
COLOR:	Cherry Up! / Tickle Me Pink! / Peek-A-Blue! / Mint For You! / Lemon Squeezy! / Midnight Magic!
SIZE:	60 × 65 × 30 mm
WEIGHT:	70g
USAGE:	Up to 1000 uses
STANDBY:	180 days
MAX NOISE LEVEL:	<60 dB
INTERFACE:	1 button

DISCLAIMER

Users of this device do so at their own risk. Neither FOREO nor its retailers assume any responsibility or liability for any injuries or damages, physical or otherwise, resulting, directly or indirectly, from the use of this device. Further, FOREO reserves the right to revise this publication and to make changes from time to time in the contents thereof without obligation to notify any person of such revision or changes.

Please take note that changes or modifications not expressly approved by the party responsible for compliance could void the user's authority to operate the equipment.

This device complies with part 15 of the FCC Rules. Operation is subject to the following two conditions:

- (1) This device may not cause harmful interference.
- (2) This device must accept any interference received, including interference that may cause undesired operation.

NOTE: 1) This equipment has been tested and found to comply with the limits for a Class B digital device, pursuant to part 15 of the FCC Rules. These limits are designed to provide reasonable protection against harmful interference in a residential installation. This equipment generates uses and can radiate radio frequency energy and, if not installed and used in accordance with the instructions, may cause harmful interference to radio communications. However, there is no guarantee that interference will not occur in a particular installation. If this equipment does cause harmful interference to radio or television reception, which can be determined by turning the equipment off and on, the user is encouraged to try to correct the interference by one or more of the following measures:

- Reorient or relocate the receiving antenna.
- Increase the separation between the equipment and receiver.
- Connect the equipment into an outlet on a circuit different from that to which the receiver is connected.
- Consult the dealer or an experienced radio / TV technician for help.

2) This device complies with CAN ICES-3 (B)/NMB-3(B). This device complies with Industry Canada licence-exempt RSS standard(s). Operation is subject to the following two conditions:

- This device may not cause interference.
- This device must accept any interference, including interference that may cause undesired operation of the device.

Under Industry Canada regulations, this radio transmitter may only operate using an antenna of a type and maximum (or lesser) gain approved for the transmitter by Industry Canada. To reduce potential radio interference to other users, the antenna type and its gain should be so chosen that the equivalent isotropically radiated power (e.i.r.p.) is not more than that necessary for successful communication.

Model may be changed for improvements without notice.

FAQs

LUNA™ play smart 2 BASICS

1. WHAT COMES WITH MY LUNA™ play smart 2?

1x LUNA™ play smart 2, 1x basic manual.

2. WHAT SHOULD I DO AFTER I RECEIVE MY LUNA™ play smart 2?

Congratulations on taking the first step toward discovering smarter skincare by acquiring LUNA™ play smart 2. Before you begin to enjoy all the benefits of sophisticated skincare technology, download the FOREO For You app for free to unlock and register your device for first time use. (For more information, please refer to the section below titled 'THE APP').

3. WHY DO I NEED TO DOWNLOAD THE FOREO For You APP BEFORE USING MY DEVICE?

All FOREO devices need to be activated and unlocked via the FOREO For You app the first time they are turned on. This helps protect against fake/copied FOREO products, and makes it easier to register the warranty and protect your investment.

4. HOW DO I TURN MY LUNA™ play smart 2 ON?

Turn your LUNA™ play smart 2 on by pressing the universal button once.

5. HOW DO I TURN MY LUNA™ play smart 2 OFF?

To turn your device off, press and hold the universal button for 3 seconds. After completing a pre-set customized cleansing routine, the device will turn off automatically.

LUNA™ play smart 2 DEVICE

6. HOW DO I CLEANSER MY SKIN?

Dampen your skin and apply your regular face cleanser. Then dampen the device. Cleanse using gentle circular movements on cheeks and forehead, gliding up and down the nose. LUNA™ play smart 2 will pause to tell you when to move to the next area of your face. Rinse and pat your face dry. Wait an additional 2 minutes for your face to fully dry and then conduct your skin analysis.

7. HOW OFTEN SHOULD I CLEANSER MY SKIN WITH LUNA™ play smart 2?

We recommend using your LUNA™ play smart 2 any time your skin needs a deep cleanse.

8. WHICH FACIAL CLEANSERS CAN BE USED WITH MY LUNA™ play smart 2?

You can use any facial cleanser with your LUNA™ play smart 2, but to keep your device in optimal condition, avoid clay-based, silicone-based, or grainy cleansers as they may damage the silicone.

9. WHAT MAKES MY LUNA™ play smart 2 MORE EFFECTIVE THAN CLEANSING DEVICES WITH NYLON BRISTLES?

Unlike nylon bristles, silicone bristles are non-porous, meaning they are resistant to bacterial buildup and 35x more hygienic than standard nylon brushes. With the help of T-Sonic™ pulsations, the soft silicone bristles remove 99.5% of dirt, oil and makeup residue.

10. CAN MY LUNA™ play smart 2 REPLACE MAKEUP REMOVERS?

We suggest you remove makeup before use for more effective cleansing.

11. WHAT IS T-SONIC™ TECHNOLOGY?

The high-efficiency motor that powers your LUNA™ play smart 2 is capable of providing more than 8,000 revolutions/minute. This high-speed movement generates subtle oscillations, which we refer to as T-Sonic pulsations. The 'T' in T-Sonic is short for transdermal - so named because these pulsations travel through the outer layers of skin, working to stimulate blood flow and loosen impurities trapped within pores.

12. HOW DO I CONDUCT MY FIRST SKIN ANALYSIS?

Make sure your skin is completely clean and dry before you begin your skin analysis. Sync your LUNA™ play smart 2 to the app, and press ANALYZE. Press and hold the skin sensors on the back of the device to your cheeks, forehead, side of nose, and chin. When the app indicates, proceed to the next area. The FOREO For You app will then analyze the moisture index of your skin, and instantaneously sync a customized cleansing routine to your device.

13. HOW OFTEN SHOULD I TAKE MY SKIN ANALYSIS?

For best results, we recommend taking your skin analysis once a week at the same time of day each time, or when traveling to a new environment.

14. WHY IS SKIN MOISTURE SO IMPORTANT?

Skin moisture acts as a protective barrier to stop the skin from becoming tight and dry. It also prevents bacteria growth, and promotes skin cell regeneration and elasticity. After analyzing your skin's moisture levels, the app will create a customized cleansing routine perfectly tailored to your skin needs, and will sync it to your device - ensuring that you always have healthy, hydrated, and glowing skin.

15. IS MY LUNA™ play smart 2 SUITABLE FOR ALL SKIN TYPES?

Yes, LUNA™ play smart 2 is specifically designed to be suitable for all skin types. LUNA™ play smart 2 features a 2-zone brush head, with thinner ultra-soft and gentle touchpoints to deeply yet delicately cleanse normal and sensitive skin types, and thicker touchpoints with increased curvature and thickness provides a deep cleanse for problematic areas such as the T-zone.

16. CAN I USE MY LUNA™ play smart 2 IF I HAVE SKIN CONDITIONS SUCH AS ACNE OR ECZEMA, OR IF I HAVE HAD A COSMETIC PROCEDURE SUCH AS BOTOX?

We suggest that anyone who suffers from a serious skin condition or has undergone a cosmetic procedure to consult their physician or skincare professionals before using LUNA™ play smart 2.

THE APP

17. HOW DO I CONNECT MY LUNA™ play smart 2 TO MY SMARTPHONE?

Download the FOREO For You app to your smartphone or tablet to register and unlock your device. Open the FOREO For You app and turn on your Bluetooth. Sync your LUNA™ device by pressing and holding the universal button for five seconds until the camera symbol on your LUNA™ play smart 2 starts blinking.

18. WHAT IS THE PURPOSE OF THE APP?

The FOREO For You app allows all FOREO devices to be unlocked and registered, which helps protect against fake/copied FOREO products, and makes it easier to register the warranty. With LUNA™ play smart 2, the app has a smart skin analysis feature that allows you to measure your skin's moisture levels. Additionally, the app then creates a personalized cleansing routine that is perfectly tailored to meet your skin's needs, and syncs it to your device for ultimate ease.

19. HOW DO I GET MY OWN CUSTOMIZED CLEANSING ROUTINE?

Sync your LUNA™ device to the FOREO For You app. Press and hold the skin sensors on the back of the device to each area of your face, as indicated in the app. The FOREO For You app will then analyze the moisture index of your skin, and instantaneously sync a customized cleansing routine to your device.

20. DOES MY LUNA™ play smart 2 WORK WITHOUT THE APP?

LUNA™ play smart 2's cleansing mode does not require use of the FOREO For You app. However, to unlock your device for the first use, you must register your device through the app and conduct a skin analysis - after which the app will automatically sync your customized cleansing routine to your device for all future uses (until the next time you conduct a skin analysis).

TROUBLESHOOTING & MAINTENANCE

21. WHAT DOES IT MEAN WHEN MY LUNA™ play smart 2 IS CONTINUOUSLY BLINKING?

If the indicator light on your device is continuously blinking, it could mean that your LUNA™ device is in Bluetooth pairing mode. Follow the instructions in the app to sync your device.

22. WHAT SHOULD I DO IF MY LUNA™ play smart 2 WON'T CONNECT TO THE FOREO FOR YOU APP?

Switch your Bluetooth off and then on again to try reconnecting. If that doesn't work, close the FOREO For You app and then reopen it to start the process over.

23. WHY IS MY LUNA™ play smart 2 NOT ACTIVATING WHEN I PRESS THE UNIVERSAL BUTTON?

If your LUNA™ play smart 2 is not activating when pressing the universal button, it means your battery is empty.

24. WHY IS MY LUNA™ play smart 2 NOT PICKING UP SKIN DURING MY SKIN ANALYSIS?

Make sure the device is completely dry and then restart the device. Be sure to firmly press both sensors flat on skin.

25. WHAT HAPPENS IF THE SKIN SENSORS GET WET?

LUNA™ play smart 2 is completely waterproof, and can even be used in the shower. However, for the most accurate results when conducting your skin analysis, make sure that both the device and your skin are completely dry before use.

26. HOW DO I CLEAN MY LUNA™ play smart 2?

Wash the brush surface with water and soap, then rinse with warm water. Pat dry with a lint-free cloth or towel. We recommend spraying the device with FOREO's Silicone Cleaning Spray and rinsing with warm water afterward for optimal results. Never use cleaning products containing alcohol, petrol, or acetone, as they may irritate the skin.

©2022 FOREO AB. ALL RIGHTS RESERVED.

EU DISTR.: FOREO AB, KARLAVÄGEN 41, 114 31 STOCKHOLM, SWEDEN.

US DISTR.: FOREO INC., 1525 E PAMA LANE, LAS VEGAS, NV 89119, USA.

AUS DISTR.: 6 PROHASKY STREET, PORT MELBOURNE, VIC, 3207 AUSTRALIA.

DESIGNED AND DEVELOPED BY FOREO SWEDEN.

MANUFACTURED FOR FOREO AB.

WWW.FOREO.COM