



Mr&Mrs  
FRAGRANCE

\* george

**EN.** Electronic fragrance diffuser for *Mr&Mrs Capsules on air* | **IT.** Diffusore elettronico di fragranze per le cialde *Mr&Mrs Capsules on air* | **DE.** Elektronischer Duftzerstäuber für die *Mr&Mrs Capsules on air* Kapseln | **FR.** Diffuseur électronique de fragrances pour les capsules *Mr&Mrs Capsules on air* | **NL.** Elektrische geurdiffuser voor de capsules van *Mr&Mrs Capsules on air* | **ES.** Difusor electrónico de fragancias para las cápsulas *Mr&Mrs Capsules on air* | **PT.** Difusor electrónico de fragrâncias para as cápsulas *Mr&Mrs Capsules on air* | **PL.** Elektroniczny dyfuzor zapachów na kapsułki *Mr&Mrs Capsules on air* | **RO.** Difuzor electronic de parfum pentru capsule *Mr&Mrs Capsules on air* | **RU.** Электронный диффузор ароматов для капсул *Mr&Mrs Capsules on air* | **SV.** Elektronisk doftspredare för kapslar av typen *Mr&Mrs Capsules on air* | **TR.** *Mr&Mrs Capsules on air* kapsülleri için elektronik koku difüzörü | **CS.** Elektronický rozptylovač vůně pro náplň *Mr&Mrs Capsules on air* | **BG.** Електронен дифузьор на аромати за капсулите *Mr&Mrs Capsules on air* | **HU.** Elektromos diffúzor *Mr&Mrs Capsules on air* illatkapszulához | **JA.** *Mr&Mrs Capsules on air* リフィル式エレクトリックディフューザー。 | **KO.** *Mr&Mrs Capsules on air* 전자 방향기 | **ZH.** *Mr&Mrs Capsules on air* 胶囊电子香氛扩散器 | **AR.** *Mr&Mrs Capsules on air* موزع العطور الإلكتروني لرقائق

Mr&Mrs Capsules®  
on air

IT patent pending - Int. Registered Design - Made in Italy

**EN.** Operation manual - Warranty | **IT.** Manuale d'uso - Garanzia | **DE.** Bedienungsanleitung - Garantie | **FR.** Notice d'emploi - Garantie | **NL.** Gebruiksaanwijzingen - Garantie | **ES.** Manual de instrucciones - Garantía | **PT.** Manual de instruções - Garantia | **PL.** Instrukcja obsługi - Gwarancja | **RO.** Manual de utilizare - Garanția | **RU.** Инструкция - Гарантия | **SV.** Handbok - Garanti | **TR.** Talimat kitabı - Garantî | **CS.** Pokyny pro použití - Záruka | **BG.** Ръководство за употреба - Гаранция | **HU.** Használati utasítás - Garancia | **JA.** 操作マニュアル - 通常保障 | **KO.** 사용 설명서 - 통상 보증서 | **ZH.** 操作手册 - 常规保修 | **AR.** كتيب التعليمات - ضمان عرفي

\* george

\* george

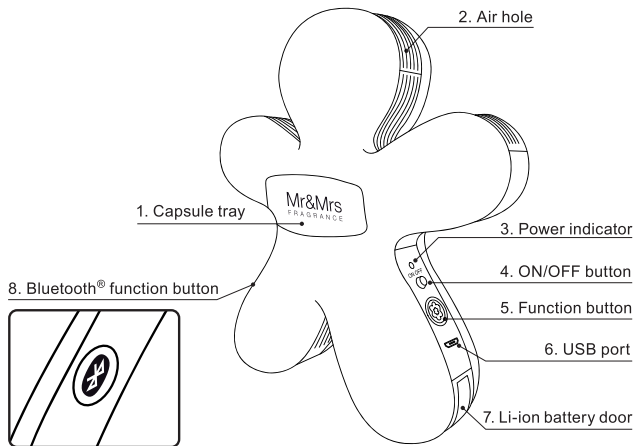

Bluetooth® available for **George Scent&Sound** edition only

The Bluetooth® word mark and logos are registered trademarks owned by Bluetooth SIG, Inc. and any use of such marks by JOY FRAGRANCES S.r.l. is under license.

## USB PORT WARNING!

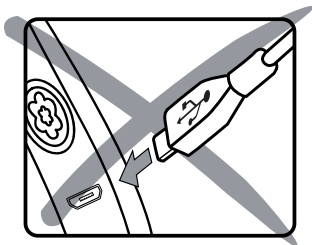
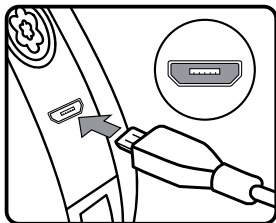

**EN. WARNING:** to avoid causing irreparable damage to the USB port of your GEORGE, plug in the USB cable with the USB symbol (⚡) facing away from you. Please refer to the images above. Any damage to the product caused by the incorrect insertion of the USB power cable will void the standard warranty.

**IT. ATTENZIONE:** per evitare di danneggiare irrimediabilmente la porta USB del vostro George, inserire la presa USB con il simbolo USB (⚡) non rivolto verso di voi. Riferitevi alle immagini sopra. Eventuali danni arrecati al prodotto, dovuti ad un inserimento errato del cavo di alimentazione USB, faranno decadere la garanzia convenzionale.

**FR. ATTENTION :** afin d'éviter d'endommager irrémédiablement le port USB de votre GEORGE insérer la prise USB avec le symbole USB (⚡) tourné vers l'intérieur. Vous référer aux images ci-dessus. D'éventuels dommages causés au produit, en raison d'une insertion erronée du câble d'alimentation USB, feront déchoir la validité de la garantie conventionnelle.

**DE. ACHTUNG:** Um unreparierbare Schäden am USB-Port Ihres GEORGE zu vermeiden, stecken Sie bitte den USB-Stecker mit dem USB-Symbol (⚡) von Ihnen wegzeigend an, wie die obigen Abbildungen zeigen. Etwaige Schäden am Produkt wegen einer falschen Verbindung des USB-Kabels fallen nicht unter die normale Garantie.

## **EN OPERATION MANUAL**

### **PROGRAMME FUNCTION**

When the ON/OFF button is pressed, the power indicator will turn BLUE.

When the function button is pressed for the first time the GREEN light will come on. The programme will start, providing a more intense emission of fragrance and operating as follows: 10 mins ON – 10 mins pause – 10 mins ON – 10 mins pause, until the battery runs out, another function is selected, or the ON/OFF button is pressed and the device is switched off.

When the function button is pressed for a second time the ORANGE light will come on. The programme will start, providing a less intense emission of fragrance and operating as follows: 12 hours ON – 12 hours pause, until the battery runs out, another function is selected, or the ON/OFF button is pressed and the device is switched off. When the function button is pressed for a third time the light switches off and the unit switches into standby mode.

### **USING BLUETOOTH®**

Switch George on by pressing the special ON/OFF button; the power indicator will turn BLUE. Activate the Bluetooth® function by pressing the Bluetooth® function button (WHITE light); it will start blinking quickly and you will hear a beep; the unit is prepared for pairing mode. Activate the Bluetooth® system on your own device and search for connections. Select "GEORGE" from the list of Bluetooth® connections that appears on your device's screen. When the two devices are correctly paired, George's Bluetooth® function button will stop blinking and you will hear a beep. You can now listen wirelessly to music via the GEORGE speaker. To adjust the volume use your own device from which the audio is playing.

### **NOTE**

- To activate the Bluetooth® signal on your own device (mobile phone, tablet, computer or any other device) consult the manufacturer's manual as the process may vary from model to model.
- In order to work effectively the device from which you are playing the audio must be in the same room as George, as the Bluetooth® range is around 9/10 metres.
- In order to maximise battery life between charges, switch off Bluetooth® when it is not in use. If a connection is not secured within 3 minutes, George's Bluetooth® function button will switch off and the unit will go into standby mode (energy saving).
- Bluetooth® version: 2.1 + EDR
- Internal speaker: 4Ω 3W

### **INSTRUCTIONS FOR RECHARGING THE UNIT**

The unit is powered by a rechargeable lithium-ion battery. You can recharge it from a computer USB port or the USB adapter, with a rated power output of DC 5V – 1A.

### **CHARGING THE BATTERY FOR THE FIRST TIME**

- Before using the unit for the first time, leave the lithium battery on charge for a minimum of 4 hours.
- When charging in OFF mode, the power indicator will be RED. When the red light switches off, the unit is fully charged.

If the unit is used for a prolonged period, functioning may become intermittent as the battery runs out; the red power indicator light will then blink to notify you that the battery should be charged as soon as possible. Connect the unit to a computer USB port or to a USB adapter (provided) using the USB cable (provided). Disconnect the USB cable from the unit as soon as it is fully charged.

**Charging when the unit is ON**

- When charging in ON mode, the power indicator light will turn PINK. When the light becomes BLUE, this means that the unit is fully charged.

**Charging when the unit is OFF**

- When you charge the unit the power indicator will be RED.
- When the RED light switches off, this means that the unit is fully charged.

*To save energy, and to prolong the life of the capsules, we recommend that you leave the device in standby mode during the night.*

**Battery charging time:**

- First time: 4 hours
- Subsequent charges: Around 2 hours

**Battery life (from fully charged to completely empty):**

- Around 6 hours 45 minutes using the FAN ONLY programme in continuous mode
- Around 4 hours using the SPEAKER ONLY programme
- Around 2 hours 40 minutes using the SPEAKER + FAN programme

**Accessories provided**

Carefully remove the unit and accessories from the box before disposing of the packaging.

**The following accessories are provided:**

- Rechargeable lithium-ion battery 3.7 V-1000mAh
- USB cable for charging the battery
- USB adapter + plug
- User manual



**WARNINGS**

Please keep this instruction manual for further reference.



Beware of small pieces and batteries, do not swallow them. It may be hazardous to your health and lead into suffocation. Please, make sure to keep small devices and batteries out of the reach of children.



Do not dispose of this product in the usual household garbage at the end of its life cycle; hand it over at a collection point for the recycling of electrical and electronic appliances. The symbol on the product, the instructions for use or the packing will inform about the methods for disposal.

The materials are recyclable as mentioned in its marking. By recycling, material recycling or other forms of re-utilization of old appliances, you are making an important contribution to protect our environment. Please inquire at the community administration for the authorized disposal location.



This appliance is not waterproof! Do not immerse the device in water. Do not allow the device to come in contact with water. If water gets inside the device it may cause serious damage. Do not use cleaning agents that contain alcohol, ammoniac, benzene or abrasives as these could damage the device. For cleaning, use a soft, moistened cloth.

\* george

\* george



**EN.** Warranty | **IT.** Garanzia | **DE.** Garantie | **FR.** Garantie | **NL.** Garantie |  
**ES.** Garantia | **PT.** Garantia | **PL.** Gwarancja | **RO.** Garanția | **RU.** Гарантия |  
**SV.** Garanti | **TR.** Garanti | **CS.** Záruka | **BG.** Гаранция | **HU.** Garancia |  
**JA.** 通常保障 | **KO.** 통상 보증서 | **ZH.** 常规保修 | **AR.** ضمان

## **EN MANUFACTURER'S WARRANTY**

Joy Fragrances S.r.l., distributor of the product contained in the packaging, thanks you for your preference and warrants that its devices are the result of the latest technology and research.

### **Warranty**

This product is warranted by Joy Fragrances S.r.l. against any manufacturing, material or working defects for a period of 24 months starting from the initial purchase date. The components or the parts which may prove to be defective because of evident manufacturing faults will be repaired or replaced by our sales network without charge during the above-mentioned period of warranty.

The warranty is limited to 6 months from the purchase date for consumables and accessories such as batteries, adapters and remote control units.

Joy Fragrances S.r.l. reserves the right to replace the device completely, should repair be impossible or too expensive, with another identical (or functionally equivalent) device during the warranty period. Repair and/or replacement, in accordance with the terms defined in this warranty, do not imply extension or renewal of the starting date for warranty terms.

### **The manufacturer's warranty does not cover possible damage caused by:**

- improper use, negligence, non-observance of instructions for use;
- unauthorized modification or repair of the product carried out by unqualified staff;
- fair wear and tear of parts;
- any modification, even if performed to ensure product conformity with safety regulations and/or national or local technical legislation in force in a Country other than the Country for which it was originally designed and manufactured;
- inadequate or non-conforming electrical installation;
- product breakage caused by falls or transport, sudden changes of voltage even if arising from atmospheric agents, leaking fluids, fire, inadequate ventilation or incorrect power supply.

### **Rights of the consumer**

The manufacturer's warranty of Joy Fragrances S.r.l. ensures specific legal rights for consumers, compatible with possible other rights which vary from State to State or from Country to Country. Consumers will be able to enforce these rights at their own discretion.

Possible extension of the warranty, promises or performances assured by the retailer which supersede the terms of the foregoing warranty will be borne by the retailer and not by Joy Fragrances S.r.l.

### **Warranty validity terms**

The warranty provided by Joy Fragrances S.r.l. and/or its sale network is valid only on presentation of proof of purchase (receipt, invoice, etc.) which enables identification of the purchased goods and the date of purchase. This document must not have any alterations or cancellations; in such a case, Joy Fragrances S.r.l. reserves the right to refuse intervention under warranty.

This certificate, correctly filled in each part, must always accompany the device in the event of repair and is only valid if accompanied by a purchase document (as indicated above).

Joy Fragrances S.r.l., Italy



## **Federal Communications Commission (FCC) Statement**

This device complies with part 15 of the FCC Rules. Operation is subject to the following two conditions: (1) This device may not cause harmful interference, and (2) this device must accept any interference received, including interference that may cause undesired operation.

**Note:** This equipment has been tested and found to comply with the limits for a Class B digital device, pursuant to part 15 of the FCC Rules. These limits are designed to provide reasonable protection against harmful interference in a residential installation. This equipment generates, uses and can radiate radio frequency energy and, if not installed and used in accordance with the instructions, may cause harmful interference to radio communications. However, there is no guarantee that interference will not occur in a particular installation. If this equipment does cause harmful interference to radio or television reception, which can be determined by turning the equipment off and on, the user is encouraged to try to correct the interference by one or more of the following measures:

- Reorient or relocate the receiving antenna.
- Increase the separation between the equipment and receiver.
- Connect the equipment into an outlet on a circuit different from that to which the receiver is connected.
- Consult the dealer or an experienced radio/TV technician for help.

**Warning:** Changes or modifications made to this device not expressly approved by GEA PROFUMI SRL may void the FCC authorization to operate this device.

**Note:** The manufacturer is not responsible for any radio or tv interference caused by unauthorized modifications to this equipment. Such modifications could void the user's authority to operate the equipment.

# Mr&Mrs

FRAGRANCE

GEORGE\_Fragrance Diffuser JGEORGE  
GEORGE\_Fragrance Diffuser JGEORGBT



Made in China



*Mr & Mrs Fragrance*

Distributed by: Joy Fragrances S.r.l.  
Via Gavinana, 14 - 21052 Busto Arsizio (VA) - ITALY  
Tel: +39 0331 536942 - [info@joyfragrances.it](mailto:info@joyfragrances.it)  
[www.mrandmrsfragrance.it](http://www.mrandmrsfragrance.it)