

USER MANUAL

Waist Massager
BeautyRelax BR-2798
Shape&Relax



CONTENT:

SAFETY NOTICE	4
PURPOSE OF USE	5
MAIN ADVANTAGES	6
PACKAGING CONTENT	7
DISPLAY DESCRIPTION	8
HOW TO USE	9
BATTERY CHARGING	10
DISPOSAL OF USED ELECTRICAL EQUIPMENT	10
CERTIFICATION	10
IMPORTER	10
ES DECLARATION OF CONFORMITY	11

Dear customer, thank you for your trust in purchasing our product. Please read all the detailed information in the instruction manual carefully before using it for the first time. Please pay particular attention to the safety warnings. Please use the device exactly as instructed. All of these steps will help to maximize the use of all functions of the instrument. In this manual we will try to give you the best possible idea of the technology used and how to use the instrument to best advantage.

If you encounter any uncertainties while reading the instructions, please do not hesitate to contact us at the following email address: mh@santadria.cz

Keep the instructions for use carefully for later reference.

SAFETY NOTICE

- Do not attempt to disassemble or repair the unit yourself in any way
- Store and use the device in a dry, closed environment (it is forbidden to use the device in the bathroom)
- It is forbidden to use the device if you have had surgery on the cervical spine or any other part of the body for which the massage device is designed
- If you are unsure, consult your GP or physiotherapist as a last resort; the device does not require any major mechanical maintenance
- Disconnect the unit from the power adapter before cleaning the controller; clean the surface of the controller only with a clean soft cloth
- Do not use aggressive cleaning agents; the surface of the controller could be damaged; do not leave the packaging material lying around; it could become a dangerous toy for children
- Handle the product with care; do not subject it to shocks, knocks or impacts; permissible ambient temperature: 5°C to +50°C
- Damage caused by neglect of these safety warnings and instructions for use will void any claim to the warranty of the device; we shall not be liable for consequential damage caused by breach of these conditions
- We do not accept any liability for personal injury caused by improper or incorrect handling of the product; in such cases, the product warranty is void

PURPOSE OF USE

The BeautyRelax Shape&Relax EMS is designed for active strengthening of the abdominal muscles. It uses electrical pulses of EMS and heat. Active muscle relaxation and strengthening. There are 8 massage programs with the possibility of setting 15 intensity levels. Two levels of heat action. Wireless use thanks to built-in li-ion battery. Easy adjustment of functions via remote control.



Note: you can use the device on the front or back of your waist as needed.

MAIN ADVANTAGES

- EMS electrical pulses
- Electrical pulses stimulate muscles as if they were actually moving
- Active muscle strengthening
- Heat action for effective muscle relaxation
- 8 massage programs
- 15 intensity levels
- 2 heat levels (38°C to 42°C, 39°C to 44°C)
- Strengthening the abdominal muscles
- Designed for the abdominal area
- Timer: yes, 30 minutes
- Ergonomic design
- Easy to set functions with the remote control
- Wireless use thanks to built-in li-ion battery
- Low battery indication
- Dimensions: 25x12x3cm
- Weight: 320g



PACKAGING CONTENT

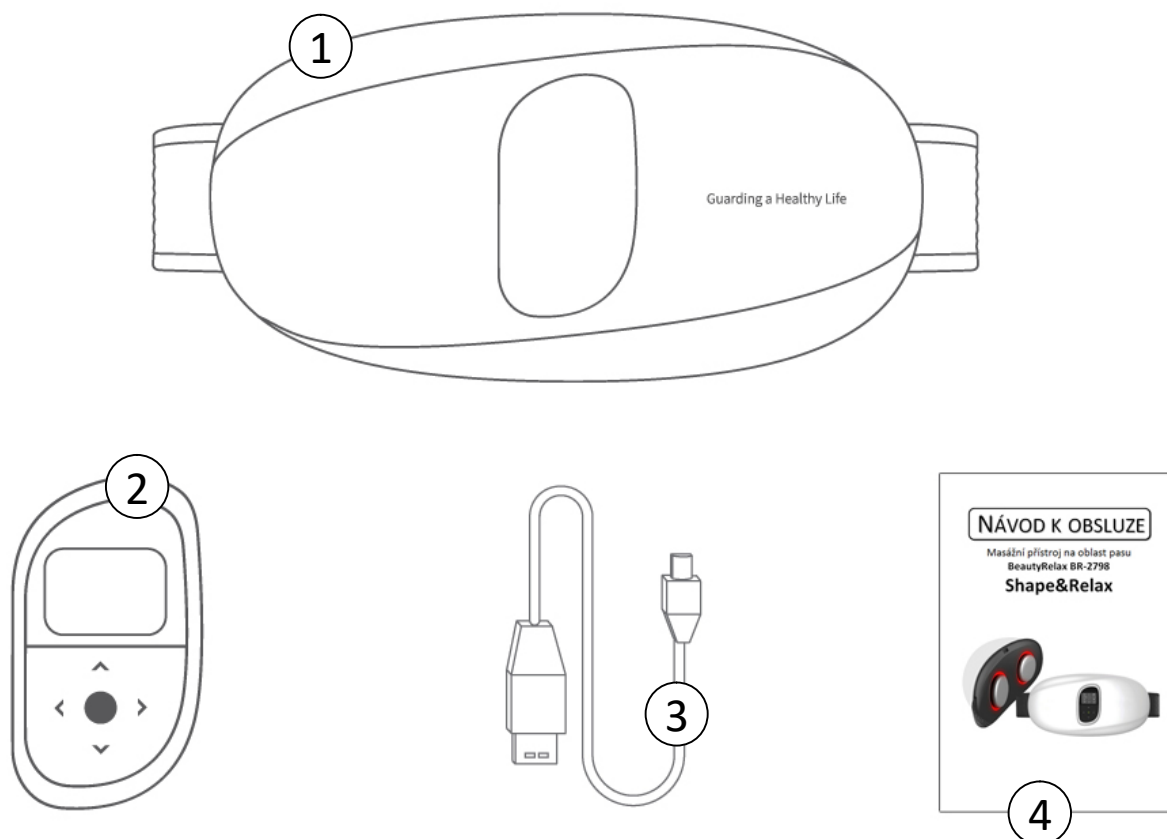

- 1.** Massager device
- 2.** Remote control
- 3.** Charging cable
- 4.** User manual



DISPLAY DESCRIPTION

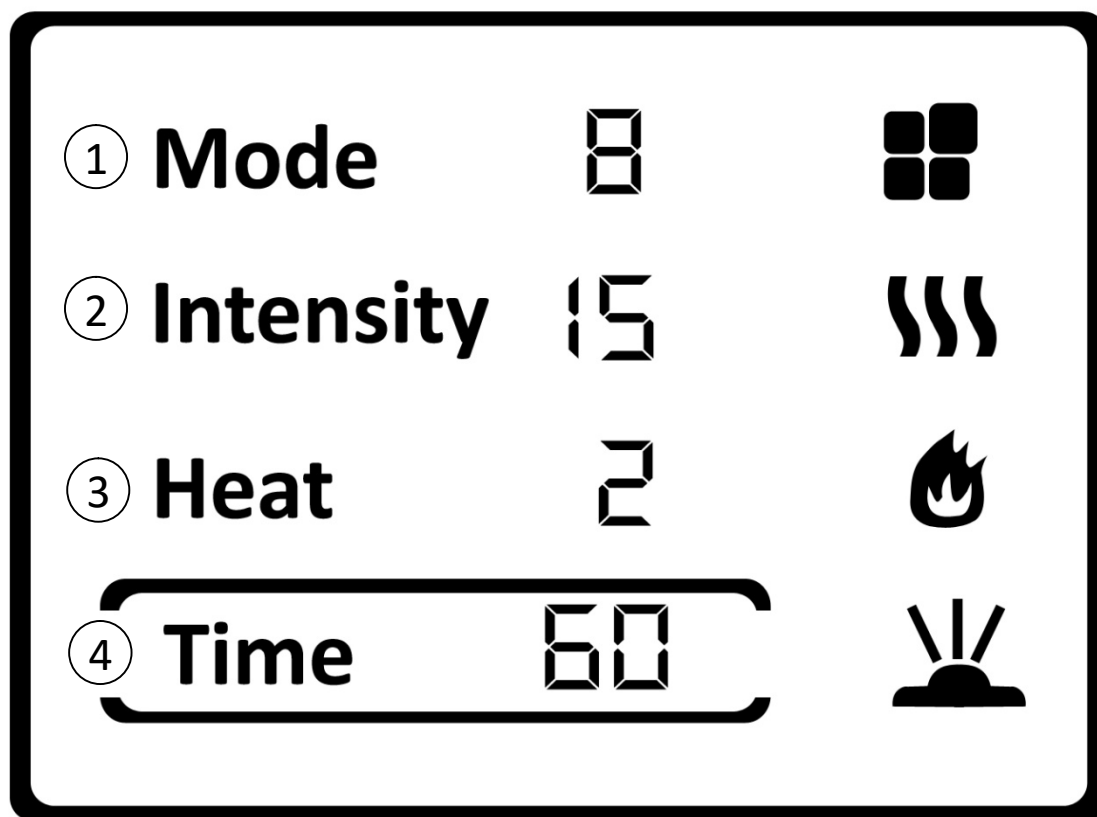

- 1. MODE** - massage program. You can easily set the massage program while using the device. There are a total of 8 programs to choose from. Their effectiveness and importance is the same. However, the user has a choice so that the use of the device is not too monotonous during long-term use.
- 2. INTENSITY** - intensity of the massage. During the use of the device you can easily adjust the intensity of the EMS pulses. There is a choice of a range from 1 to 15. You can conveniently adjust the intensity of the EMS pulses according to your current needs.
- 3. HEAT** - heating. Infrared heat flows into your body through two round applicators. In the course of using the device you can easily set the levels of heating action - off, low, high.
- 4. TIME** - time setting. The device is equipped with a timer. You can set the automatic end of the device up to 60 minutes.

HOW TO USE

- Before use, always check that both contact electrodes are clean and not covered with any grease.
- Similarly, there should be no dirt on the skin. They would create a mechanical barrier between you and the device.
- If necessary, you can apply a layer of sonogel to the skin.
- Switch on the device by long pressing the ON/OFF button on the front of the device. It is not a conventional button but a touch panel. To activate it, you need to hold your finger for a few seconds.
- Switching on the device is indicated by a red light around the applicators. The device is now in standby mode and you can start operating it with the remote control. You can turn the instrument off by long pressing the ON/OFF button on the instrument or by long pressing the ON/OFF button on the remote control (the ON/OFF button on the remote control is not used to turn the instrument on).
- Long press the ON/OFF button on the remote control to switch on the remote control.
- Use the UP and DOWN arrows to select from the menu on the remote control.
- MESSAGE PROGRAMME - MODE - Use the TRANSPORT and DOWN arrows to select the message program. There are a total of 8 programs to choose from.
- MESSAGE INTENSITY - INTENSITY - Use the UP and DOWN arrows to select the intensity of the massage. There are a total of 15 intensity levels to choose from.
- HEAT - HEAT - Use the UP and DOWN arrows to select the heat mode. The available states are **OFF 0** - **LOW 1** (38°C to 42°C) - **HIGH 2** (39°C to 44°C).
- TIME - TIME - Use the UP and DOWN arrows to set the timer mode. There is an option to set up to 60 minutes - levels 10, 20, 30, 40, 50, 60).
- You can switch the device off at any time by long pressing the ON/OFF button on the device or the controller.

BATTERY CHARGING

1. When the battery level is low, the indicator light flashes.
2. Use only the USB cable included in the package to charge the battery.
3. Connect the adapter to a USB port on your computer or laptop.
4. The charging of the battery is accompanied by a green light signal.
5. Do not use the device while it is charging.
6. The length of the charge depends on the state of the battery. It can take between 3 and 4 hours.

DISPOSAL OF USED ELECTRICAL EQUIPMENT



This symbol on products or in accompanying documents means that used electrical and electronic products must not be added to normal municipal waste. For proper disposal, refurbishment and recycling, take these products to the designated collection points. Alternatively, in some European Union or other European countries, you can return your products to your local retailer when purchasing an equivalent new product. By properly disposing of this product, you will help conserve valuable natural resources and help prevent potential negative environmental and human health impacts that could result from improper waste disposal. For further details, contact your local authority or nearest collection point. This symbol is valid in the European Union. If you wish to dispose of this product, please obtain the necessary information on the correct method of disposal from your local authorities or your dealer.

CERTIFICATION



The product is approved for use in European Union countries and bears the CE mark. The declaration of conformity and all documentation is available from the importer.

IMPORTER

SANTADRIA s.r.o. , Mojmírovo nám. 75/2 Brno, 612 00
IČO: 29195454 | DIC: CZ29195454

If you have any questions about the product, please do not hesitate to contact us:

Email: mh@santadria.cz Tel: 737196160

Printing errors, features and changes in technical parameters reserved.

ES DECLARATION OF CONFORMITY

The undersigned, representing the company

SANTADRIA s.r.o.

Mojmírovo nám. 75/2, Brno 612 00, ID: 29195454

hereby declares, as an importer into the EU, that the following product with the trade name

Waist Massager

marketed under the model name: **BR-2798**

EAN: **8594166119772**

belonging to the **BeautyRelax** brand group of products

is in compliance with the following European standards:

EN 55014-1:2017

EN 55014-2:2015

EN 61000-3-2:2014

EN 61000-3-3:2013

Based on compliance with these directives, the product has been CE marked.

The product is also compliant with RoHS Directive 2002/95/EC (RoHS). All materials are health-safe. They do not contain any heavy metals such as cadmium and other toxic substances.

For safe use, it is essential to strictly follow the instructions in the instruction manual included in the package.



Place of issue: Brno Day: 1.4.2022

.....
Martin Hrbek, Managing Director